

# PVC AND CPVC PRESSURE PIPES

## ASTM D-1785 and F-441 Schedule 80

### PVC ASTM D1785 SCHEDULE 80

PART	NOMINAL SIZE	OUTSIDE DIAMETER		PVC SCHEDULE 80			
				WALL THICKNESS		WORKING PRESSURE	WEIGHT
				IN	MM	PSI @73F	LB/FT
10022	1/8	0.41	10.41	0.095	2.41	1230	0.06
10023	1/4	0.54	13.72	0.119	3.02	1130	0.10
10024	3/8	0.68	17.15	0.126	3.20	920	0.14
10025	1/2	0.84	21.34	0.147	3.73	850	0.21
10026	3/4	1.05	26.67	0.154	3.91	690	0.28
10027	1	1.32	33.40	0.179	4.55	630	0.41
10028	1 1/4	1.66	42.16	0.191	4.85	520	0.57
10029	1 1/2	1.90	48.26	0.200	5.08	470	0.69
10030	2	2.38	60.33	0.218	5.54	400	0.96
10031	2 1/2	2.88	73.03	0.276	7.01	420	1.46
10032	3	3.50	88.90	0.300	7.62	370	1.95
10033	4	4.50	114.30	0.337	8.56	320	2.84
10034	5	5.56	141.30	0.375	9.53	290	3.95
10035	6	6.63	168.28	0.432	10.97	280	5.43
10036	8	8.63	219.08	0.500	12.70	250	8.25
10037	10	10.75	273.05	0.593	15.06	230	12.24
10038	12	12.75	323.85	0.687	17.45	230	16.83
10039	14	14.00	355.60	0.750	19.05	220	19.96
10040	16	16.00	406.40	0.843	21.41	220	26.55
10041	18	18.00	457.20	0.937	23.80	220	33.54
10042	20	20.00	508.00	1.031	26.19	220	41.05
10043	24	24.00	609.60	1.218	30.94	210	58.23

#### DERATING FACTOR

PVC	
TEMP (F)	FACTOR
73	1.00
80	0.88
90	0.75
100	0.62
110	0.51
120	0.40
130	0.31
140	0.22

### CPVC ASTM F441 SCHEDULE 80

PART	NOMINAL SIZE	OUTSIDE DIAMETER		PVC SCHEDULE 80			
				WALL THICKNESS		WORKING PRESSURE	WEIGHT
				IN	MM	PSI @180F	LB/FT
11023	1/4	0.54	13.72	0.119	3.02	283	0.12
11024	3/8	0.68	17.15	0.126	3.20	230	0.16
11025	1/2	0.84	21.34	0.147	3.73	213	0.24
11026	3/4	1.05	26.67	0.154	3.91	173	0.32
11027	1	1.32	33.40	0.179	4.55	158	0.47
11028	1 1/4	1.66	42.16	0.191	4.85	130	0.65
11029	1 1/2	1.90	48.26	0.200	5.08	118	0.79
11030	2	2.38	60.33	0.218	5.54	100	1.10
11031	2 1/2	2.88	73.03	0.276	7.01	105	1.67
11032	3	3.50	88.90	0.300	7.62	93	2.24
11033	4	4.50	114.30	0.337	8.56	80	3.28
11035	6	6.63	168.28	0.432	10.97	70	6.26
11036	8	8.63	219.08	0.500	12.70	63	9.51
11037	10	10.75	273.05	0.593	15.06	58	14.10
11038	12	12.75	323.85	0.687	17.45	58	19.39
11039	14	14.00	355.60	0.750	19.05	55	23.26
11040	16	16.00	406.40	0.843	21.41	55	29.89
11041	18	18.00	457.20	0.937	23.80	55	37.42
11042	20	20.00	508.00	1.031	26.19	55	45.88
11043	24	24.00	609.60	1.218	30.94	53	64.96

#### DERATING FACTOR

CPVC	
TEMP (F)	FACTOR
73	1.00
80	1.00
90	0.91
100	0.82
110	0.72
120	0.65
130	0.57
140	0.50
150	0.42
160	0.40
170	0.29
180	0.25
200	0.20

**Notes:** PVC/CPVC material meets ASTM Standard D-1784  
Dimensions are subject to change without notice. Contact your HYDROSEAL representative for certification.

# PVC AND CPVC PRESSURE PIPES

ASTM D-1785 and F-441 Schedule 40

SECTION

2

## PVC ASTM D1785 SCHEDULE 40

PART	NOMINAL SIZE	OUTSIDE DIAMETER		PVC SCHEDULE 40			
				WALL THICKNESS		WORKING PRESSURE	WEIGHT
				IN	MM	PSI @73F	LB/FT
10000	1/8	0.41	10.41	0.068	1.73	810	0.05
10001	1/4	0.54	13.72	0.088	2.24	780	0.09
10002	3/8	0.68	17.15	0.115	2.92	620	0.12
10003	1/2	0.84	21.34	0.109	2.77	600	0.17
10004	3/4	1.05	26.67	0.113	2.87	480	0.23
10005	1	1.32	33.40	0.133	3.38	450	0.33
10006	1 1/4	1.66	42.16	0.140	3.56	370	0.45
10007	1 1/2	1.90	48.26	0.145	3.68	330	0.54
10008	2	2.38	60.33	0.154	3.91	280	0.72
10009	2 1/2	2.88	73.03	0.203	5.16	300	1.14
10010	3	3.50	88.90	0.216	5.49	260	1.49
10011	4	4.50	114.30	0.237	6.02	220	2.12
10012	5	5.56	141.30	0.258	6.55	190	2.87
10013	6	6.63	168.28	0.280	7.11	180	3.73
10014	8	8.63	219.08	0.322	8.18	160	5.62
10015	10	10.75	273.05	0.365	9.27	140	7.97
10016	12	12.75	323.85	0.406	10.31	130	10.53
10017	14	14.00	355.60	0.438	11.13	130	12.46
10018	16	16.00	406.40	0.500	12.70	130	16.29
10019	18	18.00	457.20	0.562	14.27	130	20.59
10020	20	20.00	508.00	0.593	15.06	120	24.18
10021	24	24.00	609.60	0.687	17.45	120	33.65

### DERATING FACTOR

PVC	
TEMP (F)	FACTOR
73	1.00
80	0.88
90	0.75
100	0.62
110	0.51
120	0.40
130	0.31
140	0.22

## CPVC ASTM F441 SCHEDULE 40

PART	NOMINAL SIZE	OUTSIDE DIAMETER		CPVC SCHEDULE 40			
				WALL THICKNESS		WORKING PRESSURE	WEIGHT
				IN	MM	PSI @180F	LB/FT
11001	1/4	0.54	13.72	0.088	2.24	195	0.10
11002	3/8	0.68	17.15	0.115	2.92	155	0.13
11003	1/2	0.84	21.34	0.109	2.77	150	0.19
11004	3/4	1.05	26.67	0.113	2.87	120	0.25
11005	1	1.32	33.40	0.133	3.38	113	0.37
11006	1 1/4	1.66	42.16	0.140	3.56	93	0.50
11007	1 1/2	1.90	48.26	0.145	3.68	83	0.60
11008	2	2.38	60.33	0.154	3.91	70	0.80
11009	2 1/2	2.88	73.03	0.203	5.16	75	1.27
11010	3	3.50	88.90	0.216	5.49	65	1.66
11011	4	4.50	114.30	0.237	6.02	55	2.36
11013	6	6.63	168.28	0.280	7.11	45	4.16
11014	8	8.63	219.08	0.322	8.18	40	6.27
11015	10	10.75	273.05	0.365	9.27	35	8.89
11016	12	12.75	323.85	0.406	10.31	33	11.75
11017	14	14.00	355.60	0.438	11.13	33	13.92
11018	16	16.00	406.40	0.500	12.70	33	18.17
11019	18	18.00	457.20	0.562	14.27	33	22.97
11020	20	20.00	508.00	0.593	15.06	30	29.98
11021	24	24.00	609.60	0.687	17.45	30	37.54

### DERATING FACTOR

CPVC	
TEMP (F)	FACTOR
73	1.00
80	1.00
90	0.91
100	0.82
110	0.72
120	0.65
130	0.57
140	0.50
150	0.42
160	0.40
170	0.29
180	0.25
200	0.20

Notes: PVC/CPVC material meets ASTM Standard D-1784  
Dimensions are subject to change without notice. Contact your HYDROSEAL representative for certification.

# PVC SCHEDULE 80 FITTINGS

## Manufacturer's Product Specification

### Scope

This specification sheet covers the manufacturer's requirements for PVC Schedule 80 pipe fittings. These fittings meet or exceed the standards set by the American Society for Testing and Materials and the National Sanitation Foundation.

### PVC Materials

Rigid PVC (polyvinyl chloride) used in the manufacture of Schedule 80 fittings is Type I, Grade 1 compound as stated in ASTM D-1784. Raw material used in molding shall contain the specified amounts of color pigment, stabilizers, and other additives approved by the National Sanitation Foundation.

### Dimensions

Physical dimensions and tolerances of PVC Schedule 80 IPS (Iron Pipe Size) fittings meet the requirements of ASTM specification D-2467 for all fittings. Threaded fittings have tapered pipe threads in accordance with ANSI/ASME B1.20.1.

### Marking

PVC Schedule 80 fittings are marked as prescribed in ASTM D-2467 to indicate the manufacturer's name or trademark, size of fitting, and ASTM designation D-2467.

### Tees

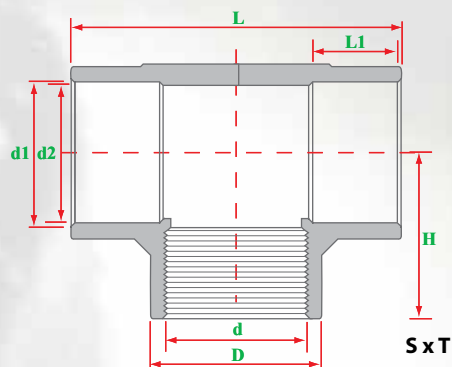
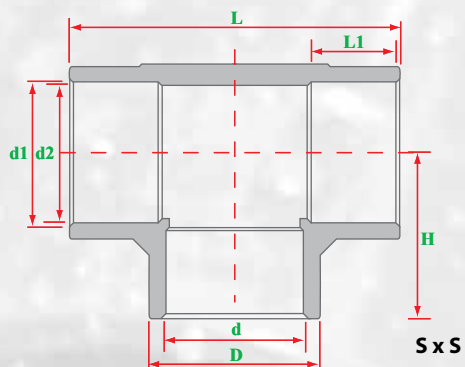

PART	NOMINAL SIZE	TEE - S x S		UNIT OF MEASURE: MM					
		D	d	d1	d2	L	L1	H	APPROX. WT.
24216	1/2"	29.5	19.00	21.54	21.23	70.00	22.50	35.00	0.05
24217	3/4"	35.0	24.00	26.87	26.57	80.00	25.50	40.00	0.07
24218	1"	43.0	31.00	33.65	33.27	95.00	29.00	47.50	0.11
24219	1 1/4"	52.5	40.00	42.42	42.04	112.00	32.00	55.00	0.17
24220	1 1/2"	59.0	46.00	48.56	48.11	124.00	35.00	62.00	0.22
24221	2"	72.0	58.00	60.63	60.17	143.00	38.50	71.50	0.34
24222	2 1/2"	87.5	70.00	73.38	72.85	167.00	44.50	83.50	0.58
24223	3"	105.0	86.00	89.31	88.70	190.00	48.00	95.00	0.86
24224	4"	132.0	110.00	114.76	114.07	235.00	57.50	117.50	1.48
24226	5"	-	-	-	-	-	-	-	3.20
24227	6"	193.0	164.00	168.83	168.00	334.00	77.00	167.00	4.30
24229	8"	245.0	214.00	219.84	218.70	448.00	100.00	224.00	8.00
24231	10"	318.0	-	273.81	272.67	585.00	140.00	292.00	21.00
24233	12"	356.0	-	324.61	323.47	672.00	160.00	338.00	29.00
24234	14"	399.0	-	356.39	-	738.00	178.00	370.00	35.00
24235	16"	450.0	-	407.19	-	866.00	204.00	433.00	38.00
24236	18"	505.0	-	457.99	-	980.00	228.00	490.00	48.00
24237	20"	563.0	-	517.07	-	1022.00	254.00	510.00	56.00
24238	24"	674.0	-	611.58	-	1225.00	305.00	613.00	84.00

PART	NOMINAL SIZE	TEE - S x T		UNIT OF MEASURE: MM					
		D	d	d1	d2	L	L1	H	APPROX. WT.
24113	1/2"	29.5	19.00	21.54	21.23	70.00	22.50	35.00	0.05
24114	3/4"	35.0	24.00	26.87	26.57	80.00	25.50	40.00	0.07
24115	1"	43.0	31.00	33.65	33.27	95.00	29.00	47.50	0.11
24116	1 1/4"	52.5	40.00	42.42	42.04	112.00	32.00	55.00	0.17
24117	1 1/2"	59.0	46.00	48.56	48.11	124.00	35.00	62.00	0.22
24118	2"	72.0	58.00	60.63	60.17	143.00	38.50	71.50	0.34
24119	2 1/2"	87.5	70.00	73.38	72.85	167.00	44.50	83.50	0.58
24120	3"	105.0	86.00	89.31	88.70	190.00	48.00	95.00	0.86
24121	4"	132.0	110.00	114.76	114.07	235.00	57.50	117.50	1.48

**Notes:** Physical dimensions and tolerances meet the requirements of ASTM Standard D-2467. PVC material meets ASTM Standard D-1784. Dimensions are subject to change without notice. Contact your HYDROSEAL representative for certification.

# PVC SCHEDULE 80 FITTINGS

## Weights, Dimensions and Tolerances

SECTION

3

### Reducing Tees

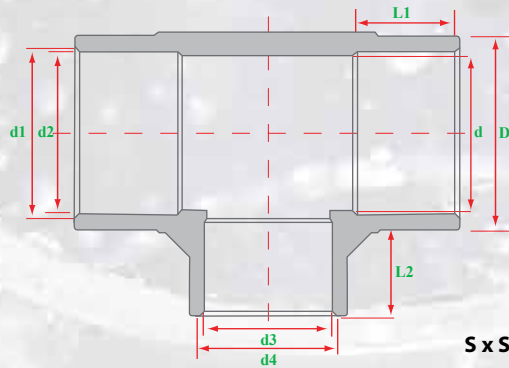

PART	NOMINAL SIZE	RED TEE - S x S		UNIT OF MEASURE: MM						
		D	d	d1	d2	d3	d4	L1	L2	APPROX. WT.
24551	3/4" > 1/2"	35.00	24.00	26.87	26.57	21.54	21.23	25.50	22.50	0.06
24554	1 > 1/2"	43.00	31.00	33.65	33.27	21.54	21.23	29.00	22.50	0.10
24555	1 > 3/4"	43.00	31.00	33.65	33.27	26.87	26.57	29.00	25.50	0.10
24558	1 1/4 > 1/2"	52.50	40.00	42.42	42.04	21.54	21.23	32.00	22.50	0.15
24559	1 1/4 > 3/4"	52.50	40.00	42.42	42.04	26.87	26.57	32.00	25.50	0.15
24560	1 1/4 > 1"	52.50	40.00	42.42	42.04	33.65	33.27	32.00	29.00	0.16
24563	1 1/2 > 1/2"	59.00	46.00	48.56	48.11	21.54	21.23	35.00	22.50	0.20
24564	1 1/2 > 3/4"	59.00	46.00	48.56	48.11	26.87	26.57	35.00	25.50	0.20
24565	1 1/2 > 1"	59.00	46.00	48.56	48.11	33.65	33.27	35.00	29.00	0.20
24566	1 1/2 > 1 1/4"	59.00	46.00	48.56	48.11	42.42	42.04	35.00	32.00	0.21
24569	2 > 1/2"	74.00	58.00	60.63	60.17	21.54	21.23	38.50	22.50	0.30
24570	2 > 3/4"	74.00	58.00	60.63	60.17	26.87	26.57	38.50	25.50	0.30
24571	2 > 1"	74.00	58.00	60.63	60.17	33.65	33.27	38.50	29.00	0.30
24572	2 > 1 1/4"	74.00	58.00	60.63	60.17	42.42	42.04	38.50	32.00	0.31
24573	2 > 1 1/2"	74.00	58.00	60.63	60.17	48.56	48.11	38.50	35.00	0.32
24578	2 1/2 > 1 1/2"	87.50	70.00	73.38	72.85	48.56	48.11	44.50	35.00	0.52
24579	2 1/2 > 2"	87.50	70.00	73.38	72.85	60.63	60.17	44.50	38.50	0.54
24582	3 > 1"	105.00	86.00	89.31	88.70	33.65	33.27	48.00	29.00	0.76
24584	3 > 1 1/2"	105.00	86.00	89.31	88.70	48.56	48.11	48.00	35.00	0.77
24585	3 > 2"	105.00	86.00	89.31	88.70	60.63	60.17	48.00	38.50	0.78
24586	3 > 2 1/2"	105.00	86.00	89.31	88.70	73.38	72.85	48.00	44.50	0.81
24592	4 > 2"	134.00	110.00	114.76	114.07	60.63	60.17	58.00	38.50	1.35
24593	4 > 2 1/2"	134.00	110.00	114.76	114.07	73.38	72.85	58.00	44.50	1.38
24594	4 > 3"	134.00	110.00	114.76	114.07	89.31	88.70	58.00	48.00	1.40
24620	6 > 3"	193.00	164.00	168.83	168.00	89.31	88.70	77.00	48.00	3.85
24621	6 > 4"	193.00	164.00	168.83	168.00	114.76	114.07	77.00	58.00	3.95
24637	8 > 6"	246.00	210.00	219.84	218.70	168.83	168.00	102.00	77.00	7.00
24650	10 > 8"	305.00	265.00	273.81	272.67	219.84	218.70	127.00	102.00	24.00
24660	12 > 10"	362.00	315.00	324.61	323.47	273.81	272.67	152.50	127.00	32.00

**Notes:** Physical dimensions and tolerances meet the requirements of ASTM Standard D-2467. PVC material meets ASTM Standard D-1784. Dimensions are subject to change without notice. Contact your HYDROSEAL representative for certification.

## PVC SCHEDULE 80 FITTINGS

Weights, Dimensions and Tolerances

### 45° Elbows

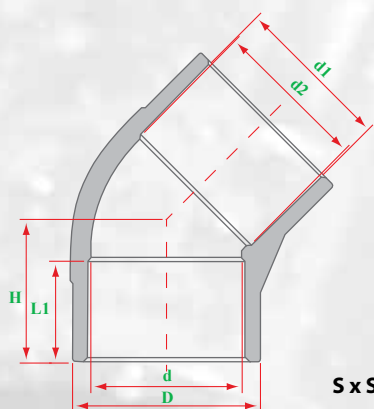

S x S

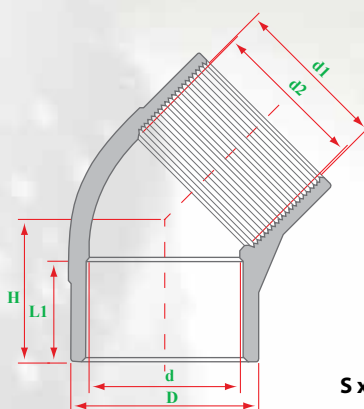

S x T

PART	NOMINAL SIZE	45 ELL - S x S		UNIT OF MEASURE: MM				
		D	d	d1	d2	L1	H	APPROX. WT.
24168	1/2"	29.5	19.00	21.54	21.23	22.50	29.50	0.03
24169	3/4"	35.0	24.00	26.87	26.57	25.50	33.00	0.04
24170	1"	43.0	31.00	33.65	33.27	29.00	38.50	0.07
24171	1 1/4"	52.5	40.00	42.42	42.04	32.00	44.00	0.11
24172	1 1/2"	59.0	46.00	48.56	48.11	35.00	48.50	0.14
24173	2"	72.0	58.00	60.63	60.17	38.50	54.50	0.21
24174	2 1/2"	87.5	70.00	73.38	72.85	44.50	63.00	0.36
24175	3"	105.0	86.00	89.31	88.70	48.00	70.00	0.55
24176	4"	132.0	110.00	114.76	114.07	57.50	85.00	0.90
24178	5"	-	-	-	-	-	-	1.67
24179	6"	193.0	164.00	168.83	168.00	77.00	119.50	2.65
24181	8"	245.0	214.00	219.84	218.70	100.00	153.90	7.00
24183	10"	318.0	-	273.81	272.67	140.00	206.30	11.00
24185	12"	356.0	-	324.61	323.47	160.00	271.40	15.00
24186	14"	399.0	-	356.39	-	178.00	298.60	21.00
24187	16"	450.0	-	407.19	-	204.00	345.00	24.00
24188	18"	505.0	-	457.99	-	228.00	381.00	32.00
24189	20"	563.0	-	517.07	-	254.00	405.00	38.00
24190	24"	674.0	-	611.58	-	305.00	478.00	53.00

PART	NOMINAL SIZE	45 ELL - S x T		UNIT OF MEASURE: MM				
		D	d	d1	d2	L1	H	APPROX. WT.
25594	1/2"	29.5	19.00	21.54	21.23	22.50	29.50	0.03
25595	3/4"	35.0	24.00	26.87	26.57	25.50	33.00	0.04
25596	1"	43.0	31.00	33.65	33.27	29.00	38.50	0.07
25597	1 1/4"	52.5	40.00	42.42	42.04	32.00	44.00	0.11
25598	1 1/2"	59.0	46.00	48.56	48.11	35.00	48.50	0.14
25599	2"	72.0	58.00	60.63	60.17	38.50	54.50	0.21
25600	2 1/2"	87.5	70.00	73.38	72.85	44.50	63.00	0.36
25601	3"	105.0	86.00	89.31	88.70	48.00	70.00	0.55
25602	4"	132.0	110.00	114.76	114.07	57.50	85.00	0.90

**Notes:** Physical dimensions and tolerances meet the requirements of ASTM Standard D-2467. PVC material meets ASTM Standard D-1784. Dimensions are subject to change without notice. Contact your HYDROSEAL representative for certification.

# PVC SCHEDULE 80 FITTINGS

## Weights, Dimensions and Tolerances

SECTION

3

### 90° Elbows

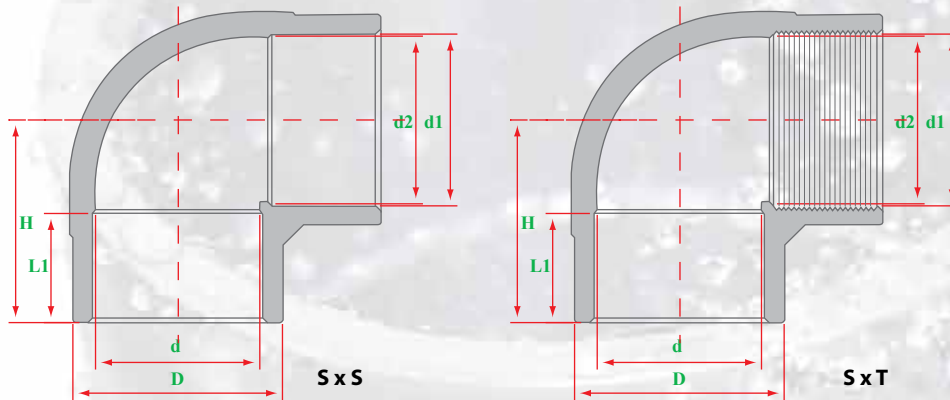

PART	NOMINAL SIZE	90 ELL - S x S		UNIT OF MEASURE: MM				APPROX. WT.
		D	d	d1	d2	L1	H	
24003	1/2"	29.5	19.00	21.54	21.23	22.50	35.00	0.03
24004	3/4"	35.0	24.00	26.87	26.57	25.50	40.00	0.05
24005	1"	43.0	31.00	33.65	33.27	29.00	47.50	0.08
24006	1 1/4"	52.5	40.00	42.42	42.04	32.00	55.00	0.13
24007	1 1/2"	59.0	46.00	48.56	48.11	35.00	62.00	0.17
24008	2"	72.0	58.00	60.63	60.17	38.50	71.50	0.26
24009	2 1/2"	87.5	70.00	73.38	72.85	44.50	83.50	0.45
24010	3"	105.0	86.00	89.31	88.70	48.00	95.00	0.70
24011	4"	132.0	110.00	114.76	114.07	57.50	117.50	1.17
24013	5"	-	-	-	-	-	-	1.94
24014	6"	193.0	164.00	168.83	168.00	77.00	167.00	3.03
24016	8"	246.0	214.00	219.84	218.70	100.00	224.00	7.80
24018	10"	314.0	-	273.81	272.67	140.00	340.00	13.00
24020	12"	362.0	-	324.61	323.47	160.00	338.00	23.00
24021	14"	397.0	-	356.39	-	178.00	369.00	27.00
24022	16"	450.0	-	407.19	-	204.00	427.00	29.00
24023	18"	505.0	-	457.99	-	228.00	490.00	38.00
24024	20"	563.0	-	517.07	-	254.00	510.00	47.00
24025	24"	674.0	-	611.58	-	305.00	617.00	63.00

PART	NOMINAL SIZE	90 ELL - S x T		UNIT OF MEASURE: MM				APPROX. WT.
		D	d	d1	d2	L1	H	
24094	1/2"	29.5	19.00	21.54	21.23	22.50	35.00	0.03
24095	3/4"	35.0	24.00	26.87	26.57	25.50	40.00	0.05
24096	1"	43.0	31.00	33.65	33.27	29.00	47.50	0.08
24097	1 1/4"	52.5	40.00	42.42	42.04	32.00	55.00	0.13
24098	1 1/2"	59.0	46.00	48.56	48.11	35.00	62.00	0.17
24099	2"	72.0	58.00	60.63	60.17	38.50	71.50	0.26
24100	2 1/2"	87.5	70.00	73.38	72.85	44.50	83.50	0.45
24101	3"	105.0	86.00	89.31	88.70	48.00	95.00	0.70
24102	4"	134.0	110.00	114.76	114.07	57.50	117.50	1.17

**Notes:** Physical dimensions and tolerances meet the requirements of ASTM Standard D-2467. PVC material meets ASTM Standard D-1784. Dimensions are subject to change without notice. Contact your HYDROSEAL representative for certification.

# PVC SCHEDULE 80 FITTINGS

## Weights, Dimensions and Tolerances

### Couplings

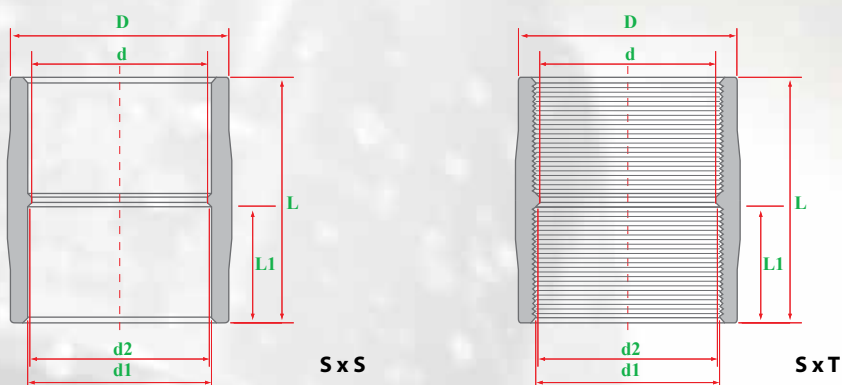

PART	NOMINAL SIZE	COUPLING - S x S		UNIT OF MEASURE: MM				APPROX. WT.
		D	d	d1	d2	L1	L	
24240	1/2"	29.5	19.00	21.54	21.23	22.50	48.00	0.02
24241	3/4"	35.0	24.00	26.87	26.57	25.50	54.00	0.03
24242	1"	43.0	31.00	33.65	33.27	29.00	61.00	0.05
24243	1 1/4"	52.5	40.00	42.42	42.04	32.00	68.00	0.08
24244	1 1/2"	59.0	46.00	48.56	48.11	35.00	74.00	0.10
24245	2"	72.0	58.00	60.63	60.17	38.50	81.00	0.14
24246	2 1/2"	87.5	70.00	73.38	72.85	44.50	93.00	0.26
24247	3"	105.0	86.00	89.31	88.70	48.00	100.00	0.38
24248	4"	132.0	110.00	114.76	114.07	57.50	120.00	0.58
24250	5"	-	-	-	-	-	-	1.06
24251	6"	193.0	164.00	168.83	168.00	77.00	162.00	1.62
24253	8"	246.0	214.00	219.84	218.70	100.00	216.00	3.17
24255	10"	305.0	-	273.81	272.67	140.00	270.00	6.00
24257	12"	370.0	-	324.61	323.47	160.00	338.00	10.00
24258	14"	393.0	-	356.39	-	178.00	406.00	14.00
24259	16"	450.0	-	407.19	-	204.00	439.00	18.00
24260	18"	505.0	-	457.99	-	228.00	496.00	22.00
24261	20"	563.0	-	517.07	-	254.00	522.00	27.00
24262	24"	674.0	-	611.58	-	305.00	652.00	34.00

PART	NOMINAL SIZE	COUPLING - T x T		UNIT OF MEASURE: MM				APPROX. WT.
		D	d	d1	d2	L1	H	
25501	1/2"	29.5	19.00	21.54	21.23	22.50	35.00	0.02
25503	3/4"	35.0	24.00	26.87	26.57	25.50	40.00	0.03
25505	1"	43.0	31.00	33.65	33.27	29.00	47.50	0.05
25507	1 1/4"	52.5	40.00	42.42	42.04	32.00	55.00	0.08
25508	1 1/2"	59.0	46.00	48.56	48.11	35.00	62.00	0.10
25509	2"	72.0	58.00	60.63	60.17	38.50	71.50	0.14
25510	2 1/2"	87.5	70.00	73.38	72.85	44.50	83.50	0.26
25511	3"	105.0	86.00	89.31	88.70	48.00	95.00	0.38
25512	4"	132.0	110.00	114.76	114.07	57.50	117.50	0.58

**Notes:** Physical dimensions and tolerances meet the requirements of ASTM Standard D-2467. PVC material meets ASTM Standard D-1784. Dimensions are subject to change without notice. Contact your HYDROSEAL representative for certification.



# PVC SCHEDULE 80 FITTINGS

## Weights, Dimensions and Tolerances

### Reducing Bushes

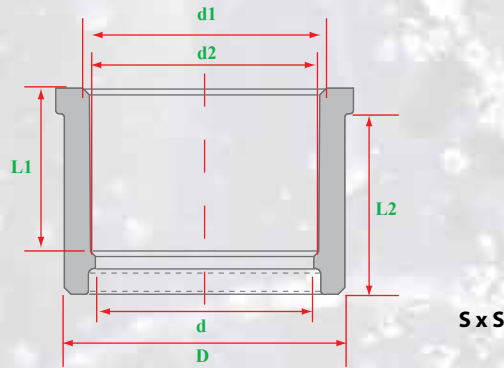

PART	NOMINAL SIZE	REDUCER - S x S		UNIT OF MEASURE: MM				
		D	d	d1	d2	L1	L2	APPROX. WT.
24819	3/4" > 1/2"	26.67	19.00	21.54	21.23	22.50	25.50	0.01
24822	1 > 1/2"	33.40	19.00	21.54	21.23	22.50	29.00	0.03
24823	1 > 3/4"	33.40	24.00	26.87	26.57	25.50	29.00	0.02
24826	1 1/4 > 1/2"	42.16	19.00	21.54	21.23	22.50	32.00	0.05
24827	1 1/4 > 3/4"	42.16	24.00	26.87	26.57	25.50	32.00	0.05
24828	1 1/4 > 1"	42.16	31.00	33.65	33.27	29.00	32.00	0.03
24831	1 1/2 > 1/2"	48.26	19.00	21.54	21.23	22.50	35.00	0.04
24832	1 1/2 > 3/4"	48.26	24.00	26.87	26.57	25.50	35.00	0.06
24833	1 1/2 > 1"	48.26	31.00	33.65	33.27	29.00	35.00	0.06
24834	1 1/2 > 1 1/4"	48.26	40.00	42.42	42.04	32.00	35.00	0.04
24837	2 > 1/2"	60.33	19.00	21.54	21.23	22.50	38.50	0.10
24838	2 > 3/4"	60.33	24.00	26.87	26.57	25.50	38.50	0.09
24839	2 > 1"	60.33	31.00	33.65	33.27	29.00	38.50	0.09
24840	2 > 1 1/4"	60.33	40.00	42.42	42.04	32.00	38.50	0.09
24841	2 > 1 1/2"	60.33	46.00	48.56	48.11	35.00	38.50	0.07
24846	2 1/2 > 1 1/2"	73.03	46.00	48.56	48.11	35.00	44.50	0.17
24847	2 1/2 > 2"	73.03	58.00	60.63	60.17	38.50	44.50	0.10
24850	3 > 1"	88.90	31.00	33.65	33.27	29.00	48.00	0.24
24852	3 > 1 1/2"	88.90	46.00	48.56	48.11	35.00	48.00	0.24
24853	3 > 2"	88.90	58.00	60.63	60.17	38.50	48.00	0.25
24854	3 > 2 1/2"	88.90	70.00	73.38	72.85	44.50	48.00	0.17
24860	4 > 2"	114.30	58.00	60.63	60.17	38.50	58.00	0.42
24861	4 > 2 1/2"	114.30	70.00	73.38	72.85	44.50	58.00	0.42
24862	4 > 3"	114.30	86.00	89.31	88.70	48.00	58.00	0.35
24863	5 > 4"	141.30	-	-	-	-	-	0.65
24886	6 > 2"	168.28	58.00	60.63	60.17	38.50	77.00	1.20
24888	6 > 3"	168.28	86.00	89.31	88.70	48.00	77.00	1.28
24889	6 > 4"	168.28	110.00	114.76	114.07	58.00	77.00	1.30
24900	8 > 2"	219.08	58.00	60.63	60.17	38.50	102.00	2.50
24902	8 > 3"	219.08	86.00	89.31	88.70	48.00	102.00	2.50
24903	8 > 4"	219.08	110.00	114.76	114.07	58.00	102.00	2.50
24905	8 > 6"	219.08	164.00	168.83	168.00	77.00	102.00	2.50
24913	10 > 4"	273.05	110.00	114.76	114.07	58.00	127.00	4.50
24916	10 > 6"	273.05	164.00	168.83	168.00	77.00	127.00	3.00
24918	10 > 8"	273.05	214.00	219.84	218.70	102.00	127.00	2.50
24926	12 > 8"	323.85	214.00	219.84	218.70	102.00	152.50	5.50
24928	12 > 10"	323.85	268.00	273.81	272.67	127.00	152.50	6.40
24934	14 > 12"	355.60	318.00	324.61	323.47	152.50	178.00	34.00
24940	16 > 14"	406.40	350.00	357.55	355.00	178.00	202.00	44.00
24943	18 > 16"	-	-	-	-	-	-	-
24946	20 > 16"	-	-	-	-	-	-	-
24947	20 > 18"	-	-	-	-	-	-	-
24948	24 > 20"	-	-	-	-	-	-	-

**Notes:** Physical dimensions and tolerances meet the requirements of ASTM Standard D-2467. PVC material meets ASTM Standard D-1784. Dimensions are subject to change without notice. Contact your HYDROSEAL representative for certification.

## Female Reducing Bushes

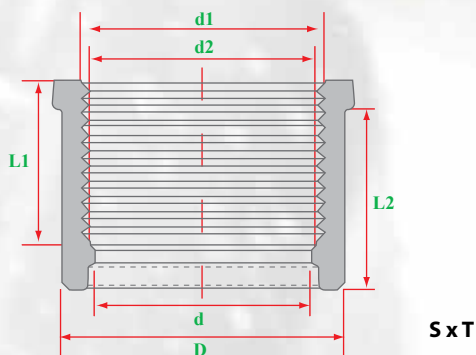

PART	NOMINAL SIZE	REDUCER - S x T		UNIT OF MEASURE: MM				
		D	d	d1	d2	L1	L2	APPROX. WT.
24999	1/2 > 3/8"	21.34	17.00	-	-	14.00	-	0.01
25000	1/2 > 1/4"	21.34	13.00	-	-	14.00	-	0.01
25001	3/4 > 1/4"	26.67	13.00	-	-	17.00	-	0.02
25002	3/4" > 1/2"	26.67	19.00	21.54	21.23	22.50	25.50	0.02
25005	1 > 1/2"	33.40	19.00	21.54	21.23	22.50	29.00	0.03
25006	1 > 3/4"	33.40	24.00	26.87	26.57	25.50	29.00	0.02
25009	1 1/4 > 1/2"	42.16	19.00	21.54	21.23	22.50	32.00	0.05
25010	1 1/4 > 3/4"	42.16	24.00	26.87	26.57	25.50	32.00	0.05
25011	1 1/4 > 1"	42.16	31.00	33.65	33.27	29.00	32.00	0.03
25014	1 1/2 > 1/2"	48.26	19.00	21.54	21.23	22.50	35.00	0.04
25015	1 1/2 > 3/4"	48.26	24.00	26.87	26.57	25.50	35.00	0.06
25016	1 1/2 > 1"	48.26	31.00	33.65	33.27	29.00	35.00	0.06
25017	1 1/2 > 1 1/4"	48.26	40.00	42.42	42.04	32.00	35.00	0.04
25020	2 > 1/2"	60.33	19.00	21.54	21.23	22.50	38.50	0.10
25021	2 > 3/4"	60.33	24.00	26.87	26.57	25.50	38.50	0.09
25022	2 > 1"	60.33	31.00	33.65	33.27	29.00	38.50	0.09
25023	2 > 1 1/4"	60.33	40.00	42.42	42.04	32.00	38.50	0.09
25024	2 > 1 1/2"	60.33	46.00	48.56	48.11	35.00	38.50	0.07
25036	3 > 2"	88.90	58.00	60.63	60.17	38.50	48.00	0.25
25043	4 > 2"	114.30	58.00	60.63	60.17	38.50	58.00	0.42
25045	4 > 3"	114.30	86.00	89.31	88.70	48.00	58.00	0.42

**Notes:** Physical dimensions and tolerances meet the requirements of ASTM Standard D-2467. PVC material meets ASTM Standard D-1784. Dimensions are subject to change without notice. Contact your HYDROSEAL representative for certification.

# PVC SCHEDULE 80 FITTINGS

## Weights, Dimensions and Tolerances

SECTION

3

### Van Stone Flanges

PART	NOMINAL SIZE	FLANGE S x S	UNIT OF MEASURE: MM						APPROX. WT.
			D	C	M	T	L	ΦE- N	
25291	1/2"	89.0	60.30	31.00	12.70	25.40	14.20	14.20	0.10
25292	3/4"	98.0	69.90	36.50	14.20	28.50	14.20	14.20	0.11
25293	1"	108.0	79.40	44.50	16.60	31.30	13.00	13.00	0.18
25294	1 1/4"	116.0	88.90	54.00	16.60	34.10	15.00	15.00	0.22
25295	1 1/2"	125.0	98.40	60.30	17.50	35.00	21.10	21.10	0.29
25296	2"	149.0	120.70	73.00	20.60	38.10	21.10	21.10	0.40
25297	2 1/2"	176.0	139.50	90.50	22.20	49.20	21.10	21.10	0.57
25298	3"	190.0	152.40	108.00	25.40	57.10	18.00	18.00	0.68
25299	4"	230.0	190.50	133.30	25.40	62.00	18.20	18.20	1.07
25301	5"	257.0	215.90	158.70	28.50	73.00	22.00	22.00	1.53
25302	6"	285.0	241.50	192.00	34.90	82.50	22.00	22.00	1.90
25304	8"	343.0	298.50	242.00	37.30	111.00	22.00	22.00	3.80
25306	10"	410.0	362.00	298.50	42.80	142.00	23.80	23.80	5.00
25308	12"	489.0	431.80	349.00	42.80	184.00	25.40	25.40	9.00
25309	14"	535.0	477.80	394.50	50.80	193.00	27.00	27.00	14.00
25310	16"	597.0	541.30	450.00	60.30	216.00	28.50	28.50	-
25311	18"	635.0	577.90	508.00	60.30	228.00	31.80	31.80	-
25312	20"	698.0	635.00	561.20	63.50	264.00	31.80	31.80	-
25313	24"	813.0	749.30	671.50	72.20	290.00	35.00	35.00	-

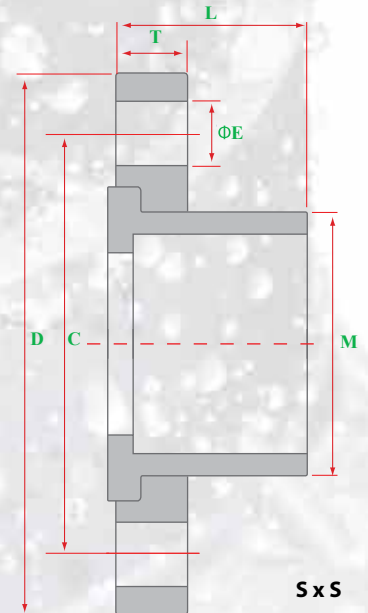

### WTF™ Flanges

PART	NOMINAL SIZE	FLANGE S x S	UNIT OF MEASURE: MM							APPROX. WT.
			D	d	d1	d2	C	T	ΦE- N	
25318	1 1/2"	140.0	46.00	48.56	48.11	111.00	19.00	17-4	0.29	
25319	2"	158.0	58.00	60.63	60.17	120.00	20.00	19-4	0.40	
25320	2 1/2"	180.0	70.00	73.38	72.85	142.00	23.00	19-4	0.57	
25321	3"	192.0	86.00	89.31	88.70	153.10	27.00	19-8	0.68	
25322	4"	230.0	110.00	114.76	114.07	184.20	28.00	19-8	1.07	
25325	6"	280.0	164.00	168.83	168.00	240.00	31.00	24-8	1.90	
25327	8"	343.0	204.00	219.84	218.70	298.00	36.00	22-8	3.80	
25328	10"	406.0	256.00	273.81	272.67	362.00	42.00	25-12	5.00	
25329	12"	481.0	307.00	324.61	324.47	432.00	42.00	25-12	9.00	

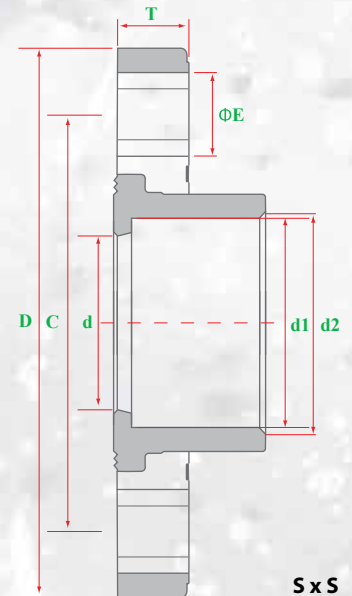

**Notes:** Physical dimensions and tolerances meet the requirements of ASTM Standard D-2467. PVC material meets ASTM Standard D-1784. Dimensions are subject to change without notice. Contact your HYDROSEAL representative for certification.

### Unions

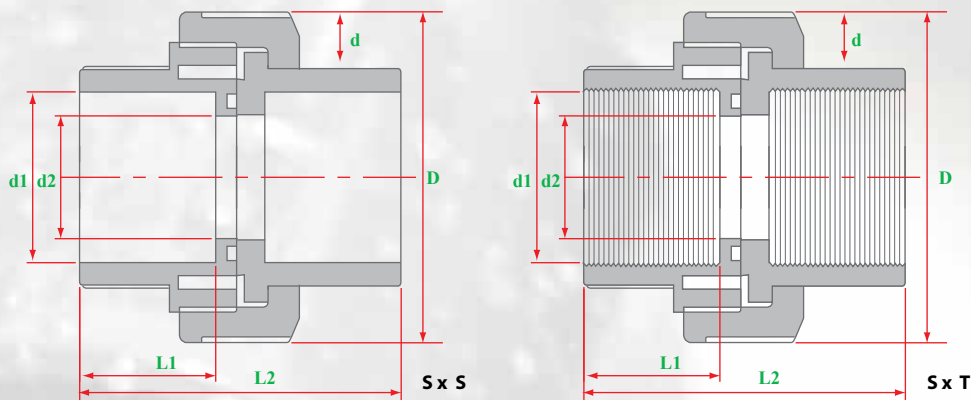

PART	NOMINAL SIZE	UNION - S x S		UNIT OF MEASURE: MM				APPROX. WT.
		D	d	d1	d2	L1	L2	
24124	1/2"	44.2	13.00	21.54	21.23	22.20	55.00	0.05
24125	3/4"	55.6	18.20	26.87	26.57	26.00	63.80	0.08
24126	1"	66.5	24.00	33.65	33.27	28.60	69.50	0.13
24127	1 1/4"	82.2	30.50	42.42	42.04	33.80	79.90	0.19
24128	1 1/2"	98.1	38.20	48.56	48.11	34.80	81.50	0.34
24129	2"	120.0	50.00	60.63	60.17	38.10	98.00	0.58
24130	2 1/2"	120.0	50.00	73.38	72.85	41.50	98.00	0.60
24131	3"	184.0	75.00	89.31	88.70	47.60	118.00	1.30
24132	4"	199.0	100.00	114.76	114.07	57.20	156.00	2.17

PART	NOMINAL SIZE	UNION - T x T		UNIT OF MEASURE: MM				APPROX. WT.
		D	d	d1	d2	L1	H	
24135	1/2"	44.2	13.00	21.54	21.23	22.20	55.00	0.05
24136	3/4"	55.6	18.20	26.87	26.57	26.00	63.80	0.08
24137	1"	66.5	24.00	33.65	33.27	28.60	69.50	0.13
24138	1 1/4"	82.2	30.50	42.42	42.04	33.80	79.90	0.19
24139	1 1/2"	98.1	38.20	48.56	48.11	34.80	81.50	0.34
24140	2"	120.0	50.00	60.63	60.17	38.10	98.00	0.58
24141	2 1/2"	120.0	50.00	73.38	72.85	41.50	98.00	0.60
24142	3"	184.0	75.00	89.31	88.70	47.60	118.00	1.30
24143	4"	199.0	100.00	114.76	114.07	57.20	156.00	2.17

**Notes:** Physical dimensions and tolerances meet the requirements of ASTM Standard D-2467. PVC material meets ASTM Standard D-1784. Dimensions are subject to change without notice. Contact your HYDROSEAL representative for certification.

# PVC SCHEDULE 80 FITTINGS

## Weights, Dimensions and Tolerances

### Nipples

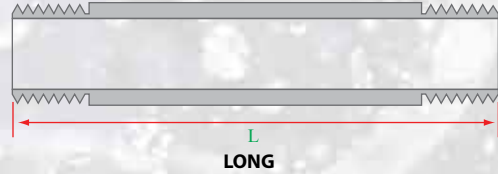
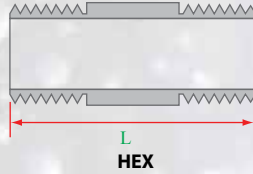
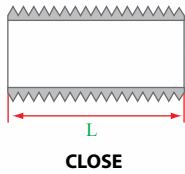

NOM. PIPE SIZE	CLOSE		HEX		3"LONG	4"LONG	5"LONG	6"LONG	8"LONG	10"LONG	12"LONG
	PART NO.	L	PART NO.	L	PART NO.	PART NO.	PART NO.	PART NO.	PART NO.	PART NO.	PART NO.
1/2	25231	1 1/4	27220	1 1/2	25674	25688	25702	25716	25730	25744	25758
3/4	25232	1 3/8	27221	2	25675	25689	25703	25717	25731	25745	25759
1	25233	1 1/2	27222	2	25676	25690	25704	25718	25732	25746	25760
1 1/4	25234	1 5/8	27223	2 1/2	25677	25691	25705	25719	25733	25747	25761
1 1/2	25235	1 3/4	27224	2 1/2	25678	25692	25706	25720	25734	25748	25762
2	25236	2	27225	2 1/2	25679	25693	25707	25721	25735	25749	25763
2 1/2	25237	2 1/2	25226	3	-	25694	25708	25722	25736	25750	25764
3	25238	2 5/8	27227	3	-	25695	27709	25723	25737	25751	25765
4	25239	2 7/8	27228	4	-	-	27710	25724	25738	25752	25766

### Male Adaptors

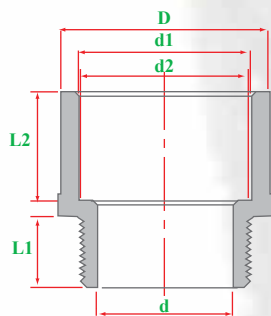

S x T

### Female Adaptors

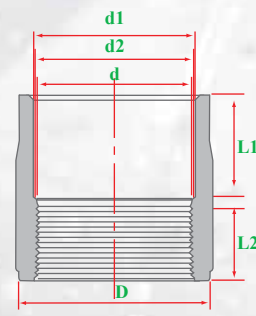

S x T

PART	NOMINAL SIZE	ADAPTOR S x T	UNIT OF MEASURE: MM						APPROX. WT.
			D	d	d1	d2	L1	L2	
25056	1/2"	29.5	15.00	21.54	21.23	22.50	18.00	0.02	
25057	3/4"	35.0	20.00	26.87	26.57	25.50	18.00	0.03	
25058	1"	43.0	25.00	33.65	33.27	29.00	20.00	0.04	
25059	1 1/4"	52.5	32.00	42.42	42.04	32.00	22.00	0.07	
25060	1 1/2"	59.0	38.00	48.56	48.11	35.00	22.00	0.09	
25061	2"	72.0	48.00	60.63	60.17	38.50	25.00	0.12	
25062	2 1/2"	87.5	60.00	73.38	72.85	44.50	32.00	0.24	
25063	3"	105.0	75.00	89.31	88.70	48.00	33.00	0.32	
25064	4"	132.0	100.00	114.76	114.07	57.50	36.00	0.55	

PART	NOMINAL SIZE	ADAPTOR S x T	UNIT OF MEASURE: MM						APPROX. WT.
			D	d	d1	d2	L1	L2	
25107	1/2"	29.5	18.00	21.54	21.23	22.50	20.00	0.02	
25108	3/4"	35.0	22.50	26.87	26.57	25.50	20.00	0.04	
25109	1"	43.0	28.00	33.65	33.27	29.00	22.50	0.06	
25110	1 1/4"	52.5	36.00	42.42	42.04	32.00	23.00	0.10	
25111	1 1/2"	59.0	43.00	48.56	48.11	35.00	25.00	0.14	
25112	2"	72.0	55.00	60.63	60.17	38.50	27.00	0.22	
25113	2 1/2"	87.5	64.00	73.38	72.85	44.50	35.00	0.34	
25114	3"	105.0	80.00	89.31	88.70	48.00	38.00	0.52	
25115	4"	132.0	106.00	114.76	114.07	57.50	38.00	0.75	

**Notes:** Physical dimensions and tolerances meet the requirements of ASTM Standard D-2467. PVC material meets ASTM Standard D-1784. Dimensions are subject to change without notice. Contact your HYDROSEAL representative for certification.

## PVC SCHEDULE 80 FITTINGS

Weights, Dimensions and Tolerances

### Wyes

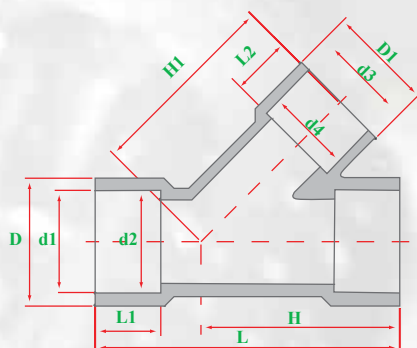

S x S x S

PART	NOMINAL SIZE	WYE - S x S x S		UNIT OF MEASURE: MM				
		D	d1	d2	L1	L	H	APPROX. WT.
25661	1/2"	31.0	21.54	21.23	22.30	82.50	50.80	-
25662	3/4"	37.3	26.87	26.57	25.40	94.50	58.70	-
25663	1"	43.0t	33.65	33.27	28.60	111.10	71.40	-
25664	1 1/4"	54.8	42.42	42.04	31.80	128.60	85.70	-
25665	1 1/2"	62.7	48.56	48.11	35.00	146.00	100.00	-
25666	2"	77.0	60.63	60.17	38.20	175.40	120.60	-
25667	2 1/2"	88.9	73.38	72.85	44.50	209.50	154.00	-
25668	3"	109.5	89.31	88.70	44.70	244.50	173.00	-
25669	4"	136.5	114.76	114.07	57.20	297.00	209.50	-
25671	6"	196.0	168.83	168.00	76.20	403.00	311.00	-
25673	8"	258.0	219.84	218.70	102.00	600.00	435.80	-

### Crosses

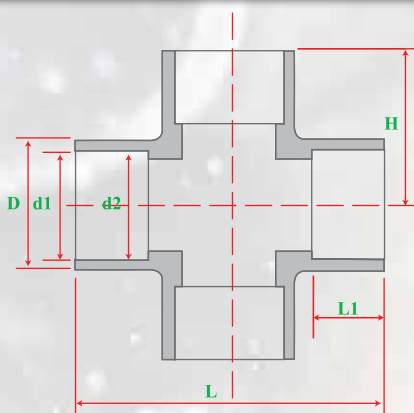

S x S x S x S

PART	NOMINAL SIZE	CROSS S x S x S x S		UNIT OF MEASURE: MM				
		D	d1	d2	L	L1	H	APPROX. WT.
24196	1/2"	30.2	21.54	21.23	69	22.3	34.1	-
24197	3/4"	35	26.87	26.57	82.5	25.4	41.3	-
24198	1"	42.8	33.65	33.27	106.4	28.6	53.2	-
24199	1 1/4"	52.4	42.42	42.04	119	28.6	59.5	-
24200	1 1/2"	61.9	48.56	48.11	133.4	35	66.7	-
24201	2"	77.8	60.63	60.17	152.4	38.2	76.2	-
24202	2 1/2"	91.3	73.38	72.85	174.6	44.5	87.3	-
24203	3"	106.3	89.31	88.70	200	47.7	100	-
24204	4"	133.3	114.76	114.07	247.6	57.2	123.8	-
24206	6"	190.5	168.83	168.00	533.4	76.2	266.7	-

**Notes:** Physical dimensions and tolerances meet the requirements of ASTM Standard D-2467. PVC material meets ASTM Standard D-1784. Dimensions are subject to change without notice. Contact your HYDROSEAL representative for certification.

# PVC SCHEDULE 80 FITTINGS

Weights, Dimensions and Tolerances

SECTION

3

## WTF™ Series Universal Van Stone Backing Rings

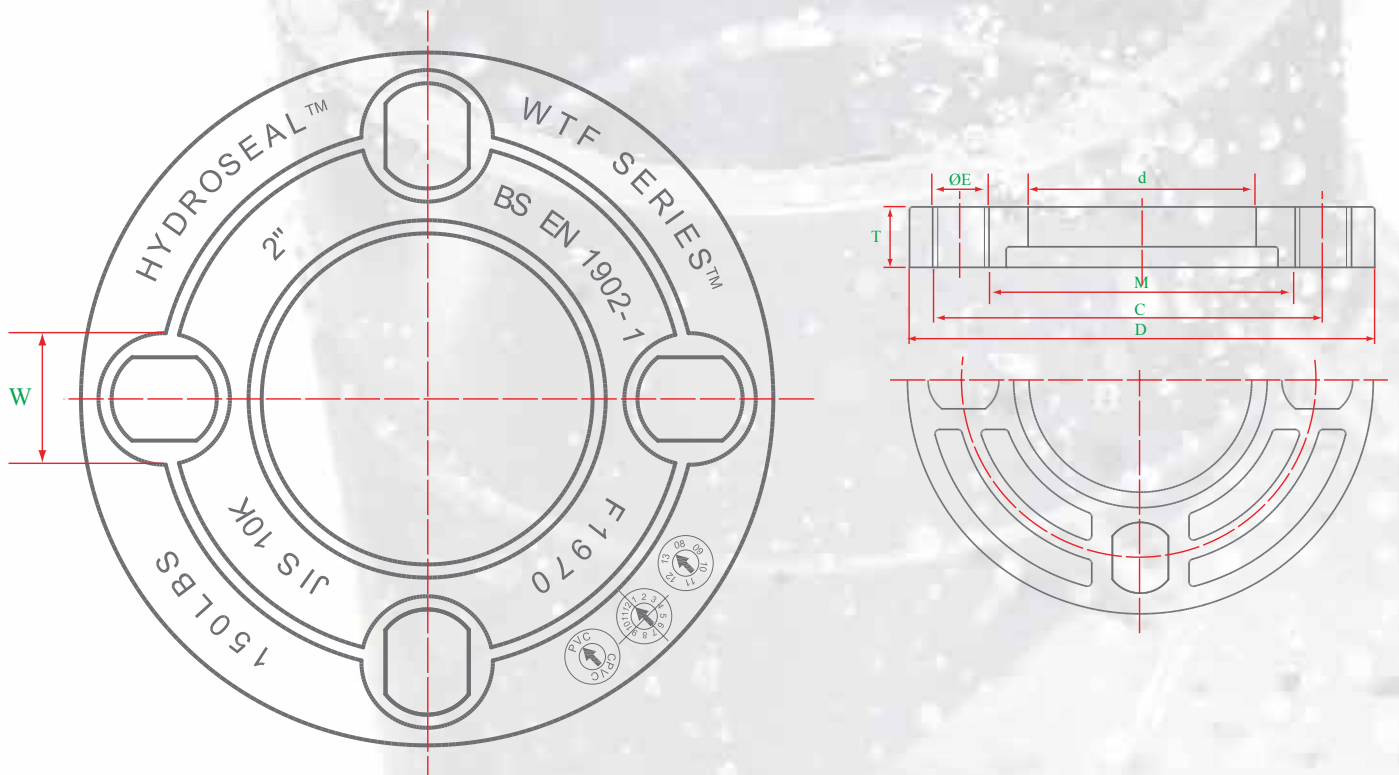

PART	NOMINAL SIZE	WTF FLANGE S x S	UNIT OF MEASURE: MM						
		d	M	C	D	T	ØE-N	W	APPROX. WT.
25314	1/2"	31.50	37.00	64.76	95.00	12.00	20.5 - 4	16.00	0.09
25315	3/4"	36.50	42.50	71.80	100.00	13.50	18.0 - 4	16.00	0.11
25316	1"	44.50	51.00	85.20	118.00	15.50	21.8 - 4	17.00	0.18
25317	1 1/4"	53.00	61.50	95.00	128.00	17.00	22.0 - 4	17.00	0.22
25318	1 1/2"	62.00	71.50	105.00	140.00	18.50	22.0 - 4	17.00	0.29
25319	2"	75.50	86.00	120.00	158.00	20.00	24.0 - 4	19.00	0.40
25320	2 1/2"	92.00	100.00	137.00	180.00	23.00	26.0 - 4	19.00	0.58
25321	3"	109.00	119.00	153.10	192.00	27.00	24.0 - 8	19.00	0.75
25322	4"	135.00	151.00	184.20	230.00	28.00	24.0 - 8	19.00	1.10
25325	6"	195.00	206.00	240.00	280.00	31.00	24.0 - 8	24.00	1.80
25329	8"	-	-	-	-	-	-	-	-

**Notes:** Flange bolt hole patterns meet ANSI B16.5 as well as BS 4504. PVC material meets ASTM Standard D-1784. Dimensions are subject to change without notice. Contact your HYDROSEAL representative for certification.

## Scope

This specification sheet covers the manufacturer's requirements for CPVC Schedule 80 pipe fittings. These fittings meet or exceed the standards set by the American Society for Testing and Materials and the National Sanitation Foundation.

## CPVC Materials

Rigid CPVC (chlorinated polyvinyl chloride) used in the manufacture of Schedule 80 fittings is Type IV, Grade 1 compound as stated in ASTM D-1784. Raw material used in molding shall contain the specified amounts of color pigment, stabilizers, and other additives approved by the National Sanitation Foundation.

## Dimensions

Physical dimensions and tolerances of CPVC Schedule 80 IPS (Iron Pipe Size) fittings meet the requirements of ASTM specification F-439 for socket type fittings and ASTM F-437 for threaded fittings. Threaded fittings have tapered pipe threads in accordance with ANSI/ASME B1.20.1.

## Marking

CPVC Schedule 80 fittings are marked as prescribed in ASTM F-439 and F-437 to indicate the manufacturer's name or trademark, size of fitting, and ASTM designation F-439 (socket) or F-437 (threaded).



# CPVC SCHEDULE 80 FITTINGS

## Weights, Dimensions and Tolerances

SECTION

3

### Tees

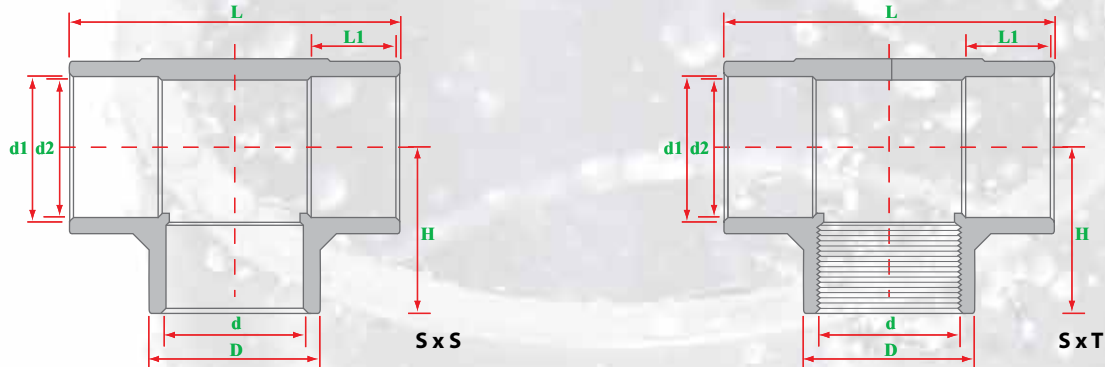

PART	NOMINAL SIZE	TEE - S x S		UNIT OF MEASURE: MM					
		D	d	d1	d2	L	L1	H	APPROX. WT.
26216	1/2"	29.5	19.00	21.54	21.23	70.00	22.50	35.00	0.05
26217	3/4"	35.0	24.00	26.87	26.57	80.00	25.50	40.00	0.07
26218	1"	43.0	31.00	33.65	33.27	95.00	29.00	47.50	0.11
26219	1 1/4"	52.5	40.00	42.42	42.04	112.00	32.00	55.00	0.17
26220	1 1/2"	59.0	46.00	48.56	48.11	124.00	35.00	62.00	0.22
26221	2"	72.0	58.00	60.63	60.17	143.00	38.50	71.50	0.34
26222	2 1/2"	87.5	70.00	73.38	72.85	167.00	44.50	83.50	0.58
26223	3"	105.0	86.00	89.31	88.70	190.00	48.00	95.00	0.86
26224	4"	132.0	110.00	114.76	114.07	235.00	57.50	117.50	1.48
26226	5"	-	-	-	-	-	-	-	3.20
26227	6"	193.0	164.00	168.83	168.00	334.00	77.00	167.00	4.30
26229	8"	245.0	214.00	219.84	218.70	448.00	100.00	224.00	8.00
26231	10"	318.0	-	273.81	272.67	585.00	140.00	292.00	21.00
26233	12"	356.0	-	324.61	323.47	672.00	160.00	338.00	29.00
26234	14"	399.0	-	356.39	-	738.00	178.00	370.00	35.00
26235	16"	450.0	-	407.19	-	866.00	204.00	433.00	38.00
26236	18"	505.0	-	457.99	-	980.00	228.00	490.00	48.00
26237	20"	563.0	-	517.07	-	1022.00	254.00	510.00	56.00
26238	24"	674.0	-	611.58	-	1225.00	305.00	613.00	84.00

PART	NOMINAL SIZE	TEE - S x T		UNIT OF MEASURE: MM					
		D	d	d1	d2	L	L1	H	APPROX. WT.
26113	1/2"	29.5	19.00	21.54	21.23	70.00	22.50	35.00	0.05
26114	3/4"	35.0	24.00	26.87	26.57	80.00	25.50	40.00	0.07
26115	1"	43.0	31.00	33.65	33.27	95.00	29.00	47.50	0.11
26116	1 1/4"	52.5	40.00	42.42	42.04	112.00	32.00	55.00	0.17
26117	1 1/2"	59.0	46.00	48.56	48.11	124.00	35.00	62.00	0.22
26118	2"	72.0	58.00	60.63	60.17	143.00	38.50	71.50	0.34
26119	2 1/2"	87.5	70.00	73.38	72.85	167.00	44.50	83.50	0.58
26120	3"	105.0	86.00	89.31	88.70	190.00	48.00	95.00	0.86
26121	4"	132.0	110.00	114.76	114.07	235.00	57.50	117.50	1.48

**Notes:** Physical dimensions and tolerances meet the requirements of ASTM Standards F-439 for socket type fittings and F-437 for threaded fittings. CPVC material meets ASTM Standard D-1784. Dimensions are subject to change without notice. Contact your HYDROSEAL representative for certification.

### Reducing Tees

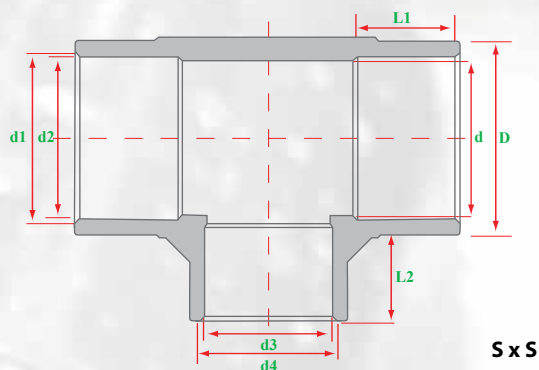

PART	NOMINAL SIZE	RED TEE - S x S								
		UNIT OF MEASURE: MM								
		D	d	d1	d2	d3	d4	L1	L2	APPROX. WT.
24551	3/4" > 1/2"	35.00	24.00	26.87	26.57	21.54	21.23	25.50	22.50	0.06
24554	1 > 1/2"	43.00	31.00	33.65	33.27	21.54	21.23	29.00	22.50	0.10
24555	1 > 3/4"	43.00	31.00	33.65	33.27	26.87	26.57	29.00	25.50	0.10
24558	1 1/4 > 1/2"	52.50	40.00	42.42	42.04	21.54	21.23	32.00	22.50	0.15
24559	1 1/4 > 3/4"	52.50	40.00	42.42	42.04	26.87	26.57	32.00	25.50	0.15
24560	1 1/4 > 1"	52.50	40.00	42.42	42.04	33.65	33.27	32.00	29.00	0.16
24563	1 1/2 > 1/2"	59.00	46.00	48.56	48.11	21.54	21.23	35.00	22.50	0.20
24564	1 1/2 > 3/4"	59.00	46.00	48.56	48.11	26.87	26.57	35.00	25.50	0.20
24565	1 1/2 > 1"	59.00	46.00	48.56	48.11	33.65	33.27	35.00	29.00	0.20
24566	1 1/2 > 1 1/4"	59.00	46.00	48.56	48.11	42.42	42.04	35.00	32.00	0.21
24569	2 > 1/2"	74.00	58.00	60.63	60.17	21.54	21.23	38.50	22.50	0.30
24570	2 > 3/4"	74.00	58.00	60.63	60.17	26.87	26.57	38.50	25.50	0.30
24571	2 > 1"	74.00	58.00	60.63	60.17	33.65	33.27	38.50	29.00	0.30
24572	2 > 1 1/4"	74.00	58.00	60.63	60.17	42.42	42.04	38.50	32.00	0.31
24573	2 > 1 1/2"	74.00	58.00	60.63	60.17	48.56	48.11	38.50	35.00	0.32
24578	2 1/2 > 1 1/2"	87.50	70.00	73.38	72.85	48.56	48.11	44.50	35.00	0.52
24579	2 1/2 > 2"	87.50	70.00	73.38	72.85	60.63	60.17	44.50	38.50	0.54
24582	3 > 1"	105.00	86.00	89.31	88.70	33.65	33.27	48.00	29.00	0.76
24584	3 > 1 1/2"	105.00	86.00	89.31	88.70	48.56	48.11	48.00	35.00	0.77
24585	3 > 2"	105.00	86.00	89.31	88.70	60.63	60.17	48.00	38.50	0.78
24586	3 > 2 1/2"	105.00	86.00	89.31	88.70	73.38	72.85	48.00	44.50	0.81
24592	4 > 2"	134.00	110.00	114.76	114.07	60.63	60.17	58.00	38.50	1.35
24593	4 > 2 1/2"	134.00	110.00	114.76	114.07	73.38	72.85	58.00	44.50	1.38
24594	4 > 3"	134.00	110.00	114.76	114.07	89.31	88.70	58.00	48.00	1.40
24620	6 > 3"	193.00	164.00	168.83	168.00	89.31	88.70	77.00	48.00	3.85
24621	6 > 4"	193.00	164.00	168.83	168.00	114.76	114.07	77.00	58.00	3.95
24637	8 > 6"	246.00	210.00	219.84	218.70	168.83	168.00	102.00	77.00	7.00
24650	10 > 8"	305.00	265.00	273.81	272.67	219.84	218.70	127.00	102.00	24.00
24660	12 > 10"	362.00	315.00	324.61	323.47	273.81	272.67	152.50	127.00	32.00

**Notes:** Physical dimensions and tolerances meet the requirements of ASTM Standards F-439 for socket type fittings and F-437 for threaded fittings. CPVC material meets ASTM Standard D-1784. Dimensions are subject to change without notice. Contact your HYDROSEAL representative for certification.

# CPVC SCHEDULE 80 FITTINGS

## Weights, Dimensions and Tolerances

### 45° Elbows

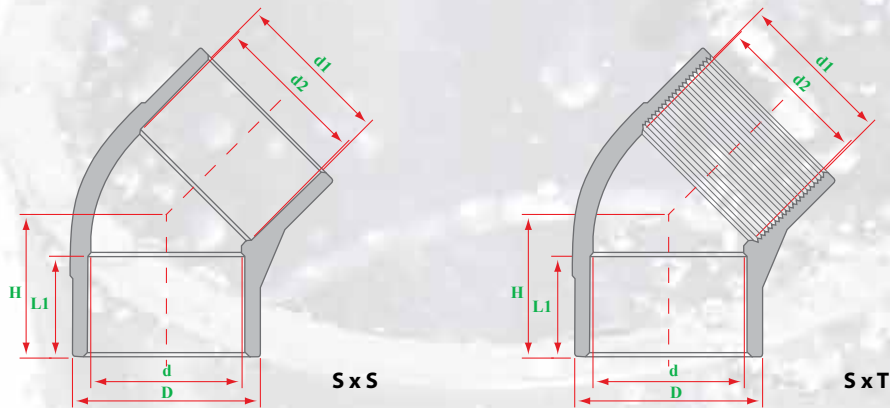

PART	NOMINAL SIZE	45 ELL - S x S		UNIT OF MEASURE: MM				
		D	d	d1	d2	L1	H	APPROX. WT.
26168	1/2"	29.5	19.00	21.54	21.23	22.50	29.50	0.03
26169	3/4"	35.0	24.00	26.87	26.57	25.50	33.00	0.04
26170	1"	43.0	31.00	33.65	33.27	29.00	38.50	0.07
26171	1 1/4"	52.5	40.00	42.42	42.04	32.00	44.00	0.11
26172	1 1/2"	59.0	46.00	48.56	48.11	35.00	48.50	0.14
26173	2"	72.0	58.00	60.63	60.17	38.50	54.50	0.21
26174	2 1/2"	87.5	70.00	73.38	72.85	44.50	63.00	0.36
26175	3"	105.0	86.00	89.31	88.70	48.00	70.00	0.55
26176	4"	132.0	110.00	114.76	114.07	57.50	85.00	0.90
26178	5"	-	-	-	-	-	-	1.67
26179	6"	193.0	164.00	168.83	168.00	77.00	119.50	2.65
26181	8"	245.0	214.00	219.84	218.70	100.00	153.90	7.00
26183	10"	318.0	-	273.81	272.67	140.00	206.30	11.00
26185	12"	356.0	-	324.61	323.47	160.00	271.40	15.00
26186	14"	399.0	-	356.39	-	178.00	298.60	21.00
26187	16"	450.0	-	407.19	-	204.00	345.00	24.00
26188	18"	505.0	-	457.99	-	228.00	381.00	32.00
26189	20"	563.0	-	517.07	-	254.00	405.00	38.00
26190	24"	674.0	-	611.58	-	305.00	478.00	53.00

PART	NOMINAL SIZE	45 ELL - S x T		UNIT OF MEASURE: MM				
		D	d	d1	d2	L1	H	APPROX. WT.
27594	1/2"	29.5	19.00	21.54	21.23	22.50	29.50	0.03
27595	3/4"	35.0	24.00	26.87	26.57	25.50	33.00	0.04
27596	1"	43.0	31.00	33.65	33.27	29.00	38.50	0.07
27597	1 1/4"	52.5	40.00	42.42	42.04	32.00	44.00	0.11
27598	1 1/2"	59.0	46.00	48.56	48.11	35.00	48.50	0.14
27599	2"	72.0	58.00	60.63	60.17	38.50	54.50	0.21
27600	2 1/2"	87.5	70.00	73.38	72.85	44.50	63.00	0.36
27601	3"	105.0	86.00	89.31	88.70	48.00	70.00	0.55
27602	4"	132.0	110.00	114.76	114.07	57.50	85.00	0.90

**Notes:** Physical dimensions and tolerances meet the requirements of ASTM Standards F-439 for socket type fittings and F-437 for threaded fittings. CPVC material meets ASTM Standard D-1784. Dimensions are subject to change without notice. Contact your HYDROSEAL representative for certification.

## 90° Elbows

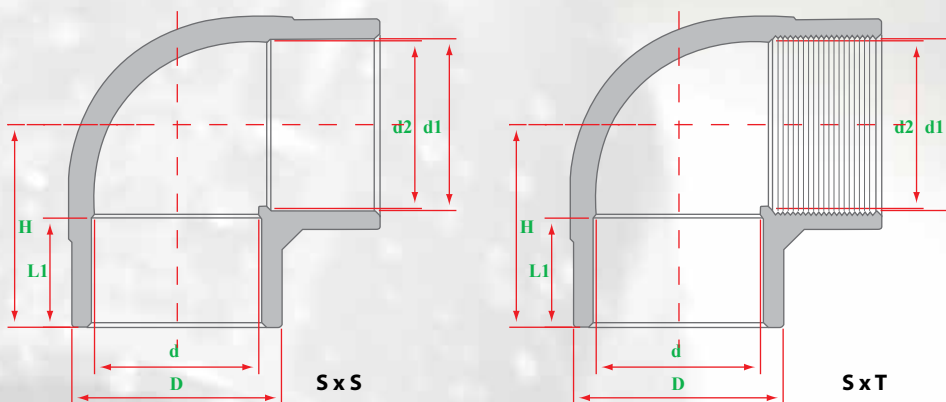

PART	NOMINAL SIZE	90 ELL - S x S		UNIT OF MEASURE: MM				APPROX. WT.
		D	d	d1	d2	L1	H	
26003	1/2"	29.5	19.00	21.54	21.23	22.50	35.00	0.03
26004	3/4"	35.0	24.00	26.87	26.57	25.50	40.00	0.05
26005	1"	43.0	31.00	33.65	33.27	29.00	47.50	0.08
26006	1 1/4"	52.5	40.00	42.42	42.04	32.00	55.00	0.13
26007	1 1/2"	59.0	46.00	48.56	48.11	35.00	62.00	0.17
26008	2"	72.0	58.00	60.63	60.17	38.50	71.50	0.26
26009	2 1/2"	87.5	70.00	73.38	72.85	44.50	83.50	0.45
26010	3"	105.0	86.00	89.31	88.70	48.00	95.00	0.70
26011	4"	132.0	110.00	114.76	114.07	57.50	117.50	1.17
26013	5"	-	-	-	-	-	-	1.94
26014	6"	193.0	164.00	168.83	168.00	77.00	167.00	3.03
26016	8"	246.0	214.00	219.84	218.70	100.00	224.00	7.80
26018	10"	314.0	-	273.81	272.67	140.00	340.00	13.00
26020	12"	362.0	-	324.61	323.47	160.00	338.00	23.00
26021	14"	397.0	-	356.39	-	178.00	369.00	27.00
26022	16"	450.0	-	407.19	-	204.00	427.00	29.00
26023	18"	505.0	-	457.99	-	228.00	490.00	38.00
26024	20"	563.0	-	517.07	-	254.00	510.00	47.00
26025	24"	674.0	-	611.58	-	305.00	617.00	63.00

PART	NOMINAL SIZE	90 ELL - S x T		UNIT OF MEASURE: MM				APPROX. WT.
		D	d	d1	d2	L1	H	
26094	1/2"	29.5	19.00	21.54	21.23	22.50	35.00	0.03
26095	3/4"	35.0	24.00	26.87	26.57	25.50	40.00	0.05
26096	1"	43.0	31.00	33.65	33.27	29.00	47.50	0.08
26097	1 1/4"	52.5	40.00	42.42	42.04	32.00	55.00	0.13
26098	1 1/2"	59.0	46.00	48.56	48.11	35.00	62.00	0.17
26099	2"	72.0	58.00	60.63	60.17	38.50	71.50	0.26
26100	2 1/2"	87.5	70.00	73.38	72.85	44.50	83.50	0.45
26101	3"	105.0	86.00	89.31	88.70	48.00	95.00	0.70
26102	4"	134.0	110.00	114.76	114.07	57.50	117.50	1.17

**Notes:** Physical dimensions and tolerances meet the requirements of ASTM Standards F-439 for socket type fittings and F-437 for threaded fittings. CPVC material meets ASTM Standard D-1784. Dimensions are subject to change without notice. Contact your HYDROSEAL representative for certification.

# CPVC SCHEDULE 80 FITTINGS

## Weights, Dimensions and Tolerances

SECTION

3

### Couplings

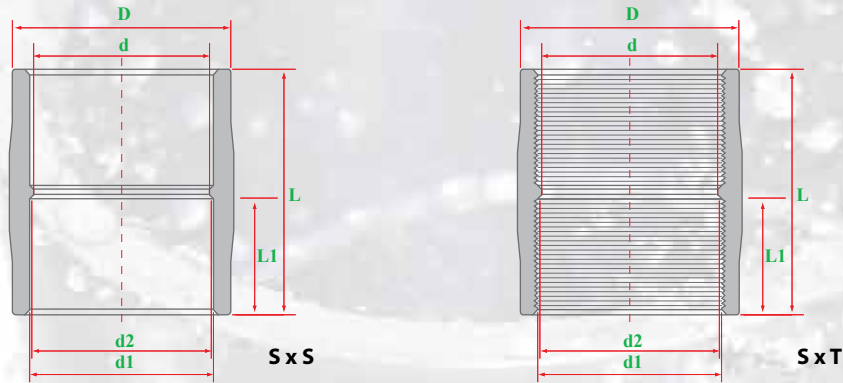

PART	NOMINAL SIZE	COUPLING - S x S		UNIT OF MEASURE: MM				
		D	d	d1	d2	L1	L	APPROX. WT.
26240	1/2"	29.5	19.00	21.54	21.23	22.50	48.00	0.02
26241	3/4"	35.0	24.00	26.87	26.57	25.50	54.00	0.03
26242	1"	43.0	31.00	33.65	33.27	29.00	61.00	0.05
26243	1 1/4"	52.5	40.00	42.42	42.04	32.00	68.00	0.08
26244	1 1/2"	59.0	46.00	48.56	48.11	35.00	74.00	0.10
26245	2"	72.0	58.00	60.63	60.17	38.50	81.00	0.14
26246	2 1/2"	87.5	70.00	73.38	72.85	44.50	93.00	0.26
26247	3"	105.0	86.00	89.31	88.70	48.00	100.00	0.38
26248	4"	132.0	110.00	114.76	114.07	57.50	120.00	0.58
26250	5"	-	-	-	-	-	-	1.06
26251	6"	193.0	164.00	168.83	168.00	77.00	162.00	1.62
26253	8"	246.0	214.00	219.84	218.70	100.00	216.00	3.17
26255	10"	305.0	-	273.81	272.67	140.00	270.00	6.00
26257	12"	370.0	-	324.61	323.47	160.00	338.00	10.00
26258	14"	393.0	-	356.39	-	178.00	406.00	14.00
26259	16"	450.0	-	407.19	-	204.00	439.00	18.00
26260	18"	505.0	-	457.99	-	228.00	496.00	22.00
26261	20"	563.0	-	517.07	-	254.00	522.00	27.00
26262	24"	674.0	-	611.58	-	305.00	652.00	34.00

PART	NOMINAL SIZE	COUPLING - T x T		UNIT OF MEASURE: MM				
		D	d	d1	d2	L1	H	APPROX. WT.
27501	1/2"	29.5	19.00	21.54	21.23	22.50	35.00	0.02
27503	3/4"	35.0	24.00	26.87	26.57	25.50	40.00	0.03
27505	1"	43.0	31.00	33.65	33.27	29.00	47.50	0.05
27507	1 1/4"	52.5	40.00	42.42	42.04	32.00	55.00	0.08
27508	1 1/2"	59.0	46.00	48.56	48.11	35.00	62.00	0.10
27509	2"	72.0	58.00	60.63	60.17	38.50	71.50	0.14
27510	2 1/2"	87.5	70.00	73.38	72.85	44.50	83.50	0.26
27511	3"	105.0	86.00	89.31	88.70	48.00	95.00	0.38
27512	4"	132.0	110.00	114.76	114.07	57.50	117.50	0.58

**Notes:** Physical dimensions and tolerances meet the requirements of ASTM Standards F-439 for socket type fittings and F-437 for threaded fittings. CPVC material meets ASTM Standard D-1784. Dimensions are subject to change without notice. Contact your HYDROSEAL representative for certification.

### Reducing Bushes

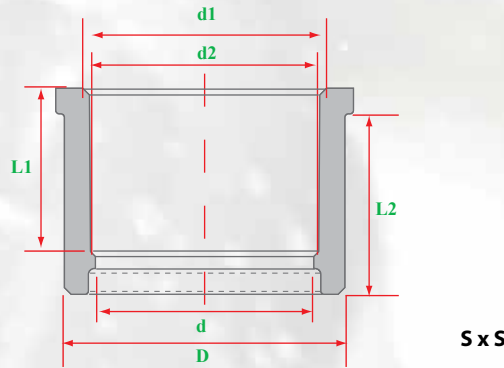

PART	NOMINAL SIZE	REDUCER - S x S		UNIT OF MEASURE: MM				
		D	d	d1	d2	L1	L2	APPROX. WT.
26819	3/4 > 1/2"	26.67	19.00	21.54	21.23	22.50	25.50	0.01
26822	1 > 1/2"	33.40	19.00	21.54	21.23	22.50	29.00	0.03
26823	1 > 3/4"	33.40	24.00	26.87	26.57	25.50	29.00	0.02
26826	1 1/4 > 1/2"	42.16	19.00	21.54	21.23	22.50	32.00	0.05
26827	1 1/4 > 3/4"	42.16	24.00	26.87	26.57	25.50	32.00	0.05
26828	1 1/4 > 1"	42.16	31.00	33.65	33.27	29.00	32.00	0.03
26831	1 1/2 > 1/2"	48.26	19.00	21.54	21.23	22.50	35.00	0.04
26832	1 1/2 > 3/4"	48.26	24.00	26.87	26.57	25.50	35.00	0.06
26833	1 1/2 > 1"	48.26	31.00	33.65	33.27	29.00	35.00	0.06
26834	1 1/2 > 1 1/4"	48.26	40.00	42.42	42.04	32.00	35.00	0.04
26837	2 > 1/2"	60.33	19.00	21.54	21.23	22.50	38.50	0.10
26838	2 > 3/4"	60.33	24.00	26.87	26.57	25.50	38.50	0.09
26839	2 > 1"	60.33	31.00	33.65	33.27	29.00	38.50	0.09
26840	2 > 1 1/4"	60.33	40.00	42.42	42.04	32.00	38.50	0.09
26841	2 > 1 1/2"	60.33	46.00	48.56	48.11	35.00	38.50	0.07
26846	2 1/2 > 1 1/2"	73.03	46.00	48.56	48.11	35.00	44.50	0.17
26847	2 1/2 > 2"	73.03	58.00	60.63	60.17	38.50	44.50	0.10
26850	3 > 1"	88.90	31.00	33.65	33.27	29.00	48.00	0.24
26852	3 > 1 1/2"	88.90	46.00	48.56	48.11	35.00	48.00	0.24
26853	3 > 2"	88.90	58.00	60.63	60.17	38.50	48.00	0.25
26854	3 > 2 1/2"	88.90	70.00	73.38	72.85	44.50	48.00	0.17
26860	4 > 2"	114.30	58.00	60.63	60.17	38.50	58.00	0.42
26861	4 > 2 1/2"	114.30	70.00	73.38	72.85	44.50	58.00	0.42
26862	4 > 3"	114.30	86.00	89.31	88.70	48.00	58.00	0.35
26863	5 > 4"	-	-	-	-	-	-	0.65
26886	6 > 2"	168.28	58.00	60.63	60.17	38.50	77.00	1.20
26888	6 > 3"	168.28	86.00	89.31	88.70	48.00	77.00	1.28
26889	6 > 4"	168.28	110.00	114.76	114.07	58.00	77.00	1.30
26900	8 > 2"	219.08	58.00	60.63	60.17	38.50	102.00	2.50
26902	8 > 3"	219.08	86.00	89.31	88.70	48.00	102.00	2.50
26903	8 > 4"	219.08	110.00	114.76	114.07	58.00	102.00	2.50
26905	8 > 6"	219.08	164.00	168.83	168.00	77.00	102.00	2.50
26913	10 > 4"	273.05	110.00	114.76	114.07	58.00	127.00	4.50
26916	10 > 6"	273.05	164.00	168.83	168.00	77.00	127.00	3.00
26918	10 > 8"	273.05	214.00	219.84	218.70	102.00	127.00	2.50
26926	12 > 8"	323.85	214.00	219.84	218.70	102.00	152.50	5.50
26928	12 > 10"	323.85	268.00	273.81	272.67	127.00	152.50	6.40
26934	14 > 12"	355.60	318.00	324.61	323.47	152.50	178.00	34.00
26940	16 > 14"	406.40	350.00	357.55	355.00	178.00	202.00	44.00
26943	18 > 16"	-	-	-	-	-	-	-
26946	20 > 16"	-	-	-	-	-	-	-
26947	20 > 18"	-	-	-	-	-	-	-
26948	24 > 20"	-	-	-	-	-	-	-

**Notes:** Physical dimensions and tolerances meet the requirements of ASTM Standards F-439 for socket type fittings and F-437 for threaded fittings. CPVC material meets ASTM Standard D-1784. Dimensions are subject to change without notice. Contact your HYDROSEAL representative for certification.

# CPVC SCHEDULE 80 FITTINGS

## Weights, Dimensions and Tolerances

SECTION

3

### Female Reducing Bushes

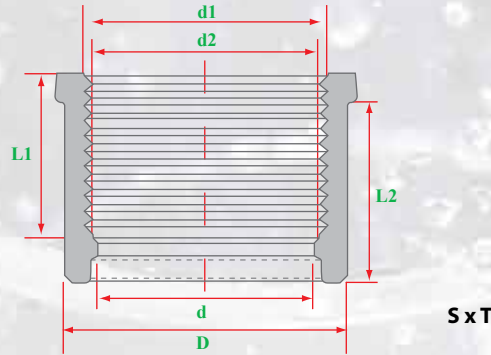

PART	NOMINAL SIZE	REDUCER - S x T	UNIT OF MEASURE: MM					
		D	d	d1	d2	L1	L2	APPROX. WT.
26999	1/2 > 3/8"	21.34	17.00	-	-	14.00	-	0.01
27000	1/2 > 1/4"	21.34	13.00	-	-	14.00	-	0.01
27001	3/4 > 1/4"	26.67	13.00	-	-	17.00	-	0.02
27002	3/4" > 1/2"	26.67	19.00	21.54	21.23	22.50	25.50	0.02
27005	1 > 1/2"	33.40	19.00	21.54	21.23	22.50	29.00	0.03
27006	1 > 3/4"	33.40	24.00	26.87	26.57	25.50	29.00	0.02
27009	1 1/4 > 1/2"	42.16	19.00	21.54	21.23	22.50	32.00	0.05
27010	1 1/4 > 3/4"	42.16	24.00	26.87	26.57	25.50	32.00	0.05
27011	1 1/4 > 1"	42.16	31.00	33.65	33.27	29.00	32.00	0.03
27014	1 1/2 > 1/2"	48.26	19.00	21.54	21.23	22.50	35.00	0.04
27015	1 1/2 > 3/4"	48.26	24.00	26.87	26.57	25.50	35.00	0.06
27016	1 1/2 > 1"	48.26	31.00	33.65	33.27	29.00	35.00	0.06
27017	1 1/2 > 1 1/4"	48.26	40.00	42.42	42.04	32.00	35.00	0.04
27020	2 > 1/2"	60.33	19.00	21.54	21.23	22.50	38.50	0.10
27021	2 > 3/4"	60.33	24.00	26.87	26.57	25.50	38.50	0.09
27022	2 > 1"	60.33	31.00	33.65	33.27	29.00	38.50	0.09
27023	2 > 1 1/4"	60.33	40.00	42.42	42.04	32.00	38.50	0.09
27024	2 > 1 1/2"	60.33	46.00	48.56	48.11	35.00	38.50	0.07
27036	3 > 2"	88.90	58.00	60.63	60.17	38.50	48.00	0.25
27043	4 > 2"	114.30	58.00	60.63	60.17	38.50	58.00	0.42
27045	4 > 3"	114.30	86.00	89.31	88.70	48.00	58.00	0.42

**Notes:** Physical dimensions and tolerances meet the requirements of ASTM Standards F-439 for socket type fittings and F-437 for threaded fittings. CPVC material meets ASTM Standard D-1784. Dimensions are subject to change without notice. Contact your HYDROSEAL representative for certification.

### Van Stone Flanges

PART	NOMINAL SIZE	FLANGE S x S	UNIT OF MEASURE: MM						
			D	C	M	T	L	ΦE-N	APPROX. WT.
27291	1/2"	89.0	60.30	31.00	12.70	25.40	14.20	14.20	0.10
27292	3/4"	98.0	69.90	36.50	14.20	28.50	14.20	14.20	0.11
27293	1"	108.0	79.40	44.50	16.60	31.30	13.00	13.00	0.18
27294	1 1/4"	116.0	88.90	54.00	16.60	34.10	15.00	15.00	0.22
27295	1 1/2"	125.0	98.40	60.30	17.50	35.00	21.10	21.10	0.29
27296	2"	149.0	120.70	73.00	20.60	38.10	21.10	21.10	0.40
27297	2 1/2"	176.0	139.50	90.50	22.20	49.20	21.10	21.10	0.57
27298	3"	190.0	152.40	108.00	25.40	57.10	18.00	18.00	0.68
27299	4"	230.0	190.50	133.30	25.40	62.00	18.20	18.20	1.07
27301	5"	257.0	215.90	158.70	28.50	73.00	22.00	22.00	1.53
27302	6"	285.0	241.50	192.00	34.90	82.50	22.00	22.00	1.90
27304	8"	343.0	298.50	242.00	37.30	111.00	22.00	22.00	3.80
27306	10"	410.0	362.00	298.50	42.80	142.00	23.80	23.80	5.00
27308	12"	489.0	431.80	349.00	42.80	184.00	25.40	25.40	9.00
27309	14"	535.0	477.80	394.50	50.80	193.00	27.00	27.00	14.00
27310	16"	597.0	541.30	450.00	60.30	216.00	28.50	28.50	-
27311	18"	635.0	577.90	508.00	60.30	228.00	31.80	31.80	-
27312	20"	698.0	635.00	561.20	63.50	264.00	31.80	31.80	-
27313	24"	813.0	749.30	671.50	72.20	290.00	35.00	35.00	-

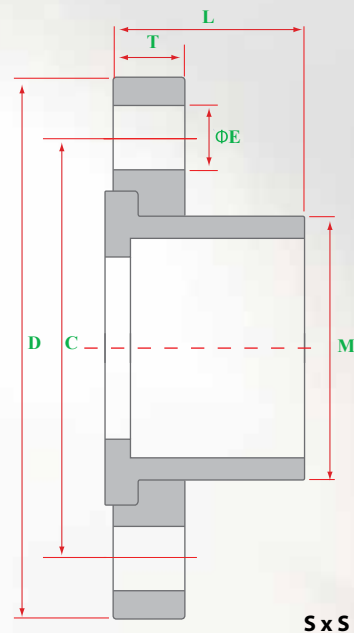

### WTF Flanges

PART	NOMINAL SIZE	FLANGE S x S	UNIT OF MEASURE: MM						
			D	d	d1	d2	C	T	ΦE-N
27318	1 1/2"	140.0	46.00	48.56	48.11	111.00	19.00	17 - 4	0.29
27319	2"	158.0	58.00	60.63	60.17	120.00	20.00	19 - 4	0.40
27320	2 1/2"	180.0	70.00	73.38	72.85	142.00	23.00	19 - 4	0.57
27321	3"	192.0	86.00	89.31	88.70	153.10	27.00	19 - 8	0.68
27322	4"	230.0	110.00	114.76	114.07	184.20	28.00	19 - 8	1.07
27325	6"	280.0	164.00	168.83	168.00	240.00	31.00	24 - 8	1.90
27327	8"	343.0	204.00	219.84	218.70	298.00	36.00	22 - 8	3.80
27328	10"	406.0	256.00	273.81	272.67	362.00	42.00	25 - 12	5.00
27329	12"	481.0	307.00	324.61	324.47	432.00	42.00	25 - 12	9.00

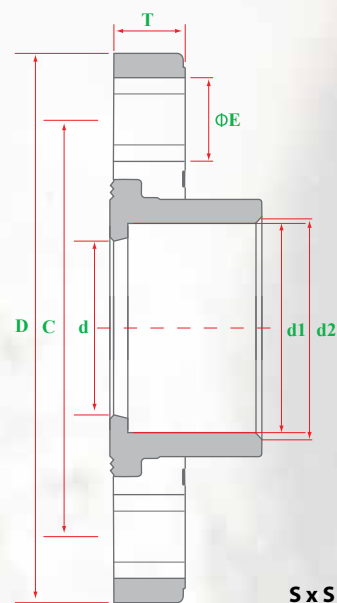

**Notes:** Physical dimensions and tolerances meet the requirements of ASTM Standards F-439 for socket type fittings and F-437 for threaded fittings. CPVC material meets ASTM Standard D-1784. Dimensions are subject to change without notice. Contact your HYDROSEAL representative for certification.



# CPVC SCHEDULE 80 FITTINGS

## Weights, Dimensions and Tolerances

SECTION

3

### Unions

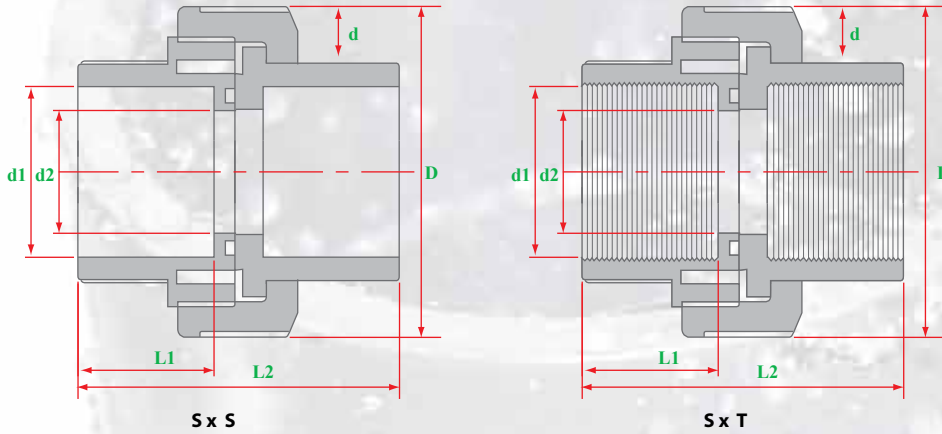

PART	NOMINAL SIZE	UNION - S x S	UNIT OF MEASURE: MM					APPROX. WT.
		D	d	d1	d2	L1	L2	
26124	1/2"	44.2	13.00	21.54	21.23	22.20	55.00	0.05
26125	3/4"	55.6	18.20	26.87	26.57	26.00	63.80	0.08
26126	1"	66.5	24.00	33.65	33.27	28.60	69.50	0.13
26127	1 1/4"	82.2	30.50	42.42	42.04	33.80	79.90	0.19
26128	1 1/2"	98.1	38.20	48.56	48.11	34.80	81.50	0.34
26129	2"	120.0	50.00	60.63	60.17	38.10	98.00	0.58
26130	2 1/2"	120.0	50.00	73.38	72.85	41.50	98.00	0.60
26131	3"	184.0	75.00	89.31	88.70	47.60	118.00	1.30
26132	4"	199.0	100.00	114.76	114.07	57.20	156.00	2.17

PART	NOMINAL SIZE	UNION - T x T	UNIT OF MEASURE: MM					APPROX. WT.
		D	d	d1	d2	L1	H	
26135	1/2"	44.2	13.00	21.54	21.23	22.20	55.00	0.05
26136	3/4"	55.6	18.20	26.87	26.57	26.00	63.80	0.08
26137	1"	66.5	24.00	33.65	33.27	28.60	69.50	0.13
26138	1 1/4"	82.2	30.50	42.42	42.04	33.80	79.90	0.19
26139	1 1/2"	98.1	38.20	48.56	48.11	34.80	81.50	0.34
26140	2"	120.0	50.00	60.63	60.17	38.10	98.00	0.58
26141	2 1/2"	120.0	50.00	73.38	72.85	41.50	98.00	0.60
26142	3"	184.0	75.00	89.31	88.70	47.60	118.00	1.30
26143	4"	199.0	100.00	114.76	114.07	57.20	156.00	2.17

**Notes:** Physical dimensions and tolerances meet the requirements of ASTM Standards F-439 for socket type fittings and F-437 for threaded fittings. CPVC material meets ASTM Standard D-1784. Dimensions are subject to change without notice. Contact your HYDROSEAL representative for certification.

### Nipples

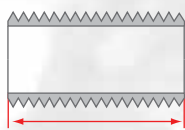

CLOSE

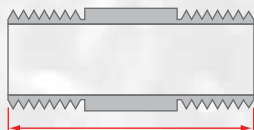

HEX

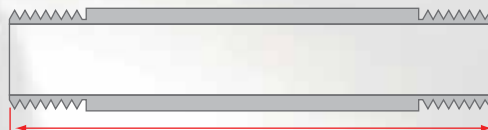

LONG

NOM. PIPE SIZE	CLOSE		HEX		3"LONG	4"LONG	5"LONG	6"LONG	8"LONG	10"LONG	12"LONG
	PART NO.	L	PART NO.	L	PART NO.	PART NO.	PART NO.	PART NO.	PART NO.	PART NO.	PART NO.
1/2"	25231	1 1/4"	27220	1 1/2"	25674	25688	25702	25716	25730	25744	25758
3/4"	25232	1 3/8"	27221	2"	25675	25689	25703	25717	25731	25745	25759
1"	25233	1 1/2"	27222	2"	25676	25690	25704	25718	25732	25746	25760
1 1/4"	25234	1 5/8"	27223	2 1/2"	25677	25691	25705	25719	25733	25747	25761
1 1/2"	25235	1 3/4"	27224	2 1/2"	25678	25692	25706	25720	25734	25748	25762
2"	25236	2"	27225	2 1/2"	25679	25693	25707	25721	25735	25749	25763
2 1/2"	25237	2 1/2"	25226	3"	-	25694	25708	25722	25736	25750	25764
3"	25238	2 5/8"	27227	3"	-	25695	27709	25723	25737	25751	25765
4"	25239	2 7/8"	27228	4"	-	-	27710	25724	25738	25752	25766

### Male Adaptors

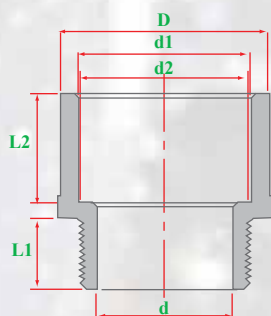

S x T

### Female Adaptors

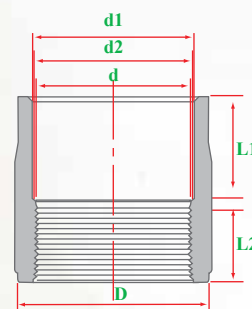

S x T

PART	NOMINAL SIZE	ADAPTOR S x T	UNIT OF MEASURE: MM						APPROX. WT.
			D	d	d1	d2	L1	L2	
27056	1/2"	29.5	15.00	21.54	21.23	22.50	18.00	0.02	
27057	3/4"	35.0	20.00	26.87	26.57	25.50	18.00	0.03	
27058	1"	43.0	25.00	33.65	33.27	29.00	20.00	0.04	
27059	1 1/4"	52.5	32.00	42.42	42.04	32.00	22.00	0.07	
27060	1 1/2"	59.0	38.00	48.56	48.11	35.00	22.00	0.09	
27061	2"	72.0	48.00	60.63	60.17	38.50	25.00	0.12	
27062	2 1/2"	87.5	60.00	73.38	72.85	44.50	32.00	0.24	
27063	3"	105.0	75.00	89.31	88.70	48.00	33.00	0.32	
27064	4"	132.0	100.00	114.76	114.07	57.50	36.00	0.55	

PART	NOMINAL SIZE	ADAPTOR S x T	UNIT OF MEASURE: MM						APPROX. WT.
			D	d	d1	d2	L1	L2	
27107	1/2"	29.5	18.00	21.54	21.23	22.50	20.00	0.02	
27108	3/4"	35.0	22.50	26.87	26.57	25.50	20.00	0.04	
27109	1"	43.0	28.00	33.65	33.27	29.00	22.50	0.06	
27110	1 1/4"	52.5	36.00	42.42	42.04	32.00	23.00	0.10	
27111	1 1/2"	59.0	43.00	48.56	48.11	35.00	25.00	0.14	
27112	2"	72.0	55.00	60.63	60.17	38.50	27.00	0.22	
27113	2 1/2"	87.5	64.00	73.38	72.85	44.50	35.00	0.34	
27114	3"	105.0	80.00	89.31	88.70	48.00	38.00	0.52	
27115	4"	132.0	106.00	114.76	114.07	57.50	38.00	0.75	

**Notes:** Physical dimensions and tolerances meet the requirements of ASTM Standards F-439 for socket type fittings and F-437 for threaded fittings. CPVC material meets ASTM Standard D-1784. Dimensions are subject to change without notice. Contact your HYDROSEAL representative for certification.

# CPVC SCHEDULE 80 FITTINGS

## Weights, Dimensions and Tolerances

### Wyes

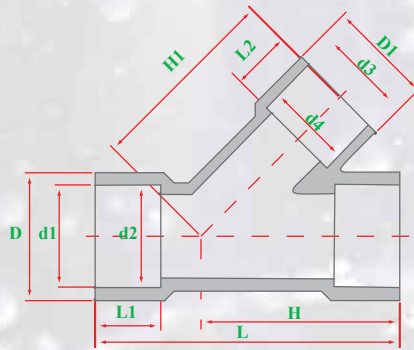

S x S x S

PART	NOMINAL SIZE	WYE - S x S x S		UNIT OF MEASURE: MM				APPROX. WT.
		D	d1	d2	L1	L	H	
27661	1/2"	31.0	21.54	21.23	22.30	82.50	50.80	-
27662	3/4"	37.3	26.87	26.57	25.40	94.50	58.70	-
27663	1"	43.0	33.65	33.27	28.60	111.10	71.40	-
27664	1 1/4"	54.8	42.42	42.04	31.80	128.60	85.70	-
27665	1 1/2"	62.7	48.56	48.11	35.00	146.00	100.00	-
27666	2"	77.0	60.63	60.17	38.20	175.40	120.60	-
27667	2 1/2"	88.9	73.38	72.85	44.50	209.50	154.00	-
27668	3"	109.5	89.31	88.70	44.70	244.50	173.00	-
27669	4"	136.5	114.76	114.07	57.20	297.00	209.50	-
27671	6"	196.0	168.83	168.00	76.20	403.00	311.00	-
27673	8"	258.0	219.84	218.70	102.00	600.00	435.80	-

### Crosses

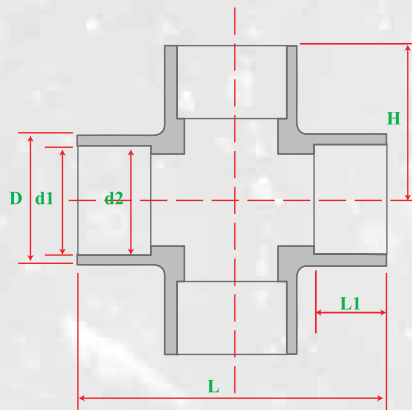

S x S x S x S

PART	NOMINAL SIZE	CROSS - S x S x S x S			UNIT OF MEASURE: MM			APPROX. WT.
		D	d1	d2	L	L1	H	
26196	1/2"	30.2	21.54	21.23	69	22.3	34.1	-
26197	3/4"	35	26.87	26.57	82.5	25.4	41.3	-
26198	1"	42.8	33.65	33.27	106.4	28.6	53.2	-
26199	1 1/4"	52.4	42.42	42.04	119	28.6	59.5	-
26200	1 1/2"	61.9	48.56	48.11	133.4	35	66.7	-
26201	2"	77.8	60.63	60.17	152.4	38.2	76.2	-
26202	2 1/2"	91.3	73.38	72.85	174.6	44.5	87.3	-
26203	3"	106.3	89.31	88.70	200	47.7	100	-
26204	4"	133.3	114.76	114.07	247.6	57.2	123.8	-
26206	6"	190.5	168.83	168.00	533.4	76.2	266.7	-

**Notes:** Physical dimensions and tolerances meet the requirements of ASTM Standards F-439 for socket type fittings and F-437 for threaded fittings. CPVC material meets ASTM Standard D-1784. Dimensions are subject to change without notice. Contact your HYDROSEAL representative for certification.

## WTF™ Series Universal Van Stone Backing Rings

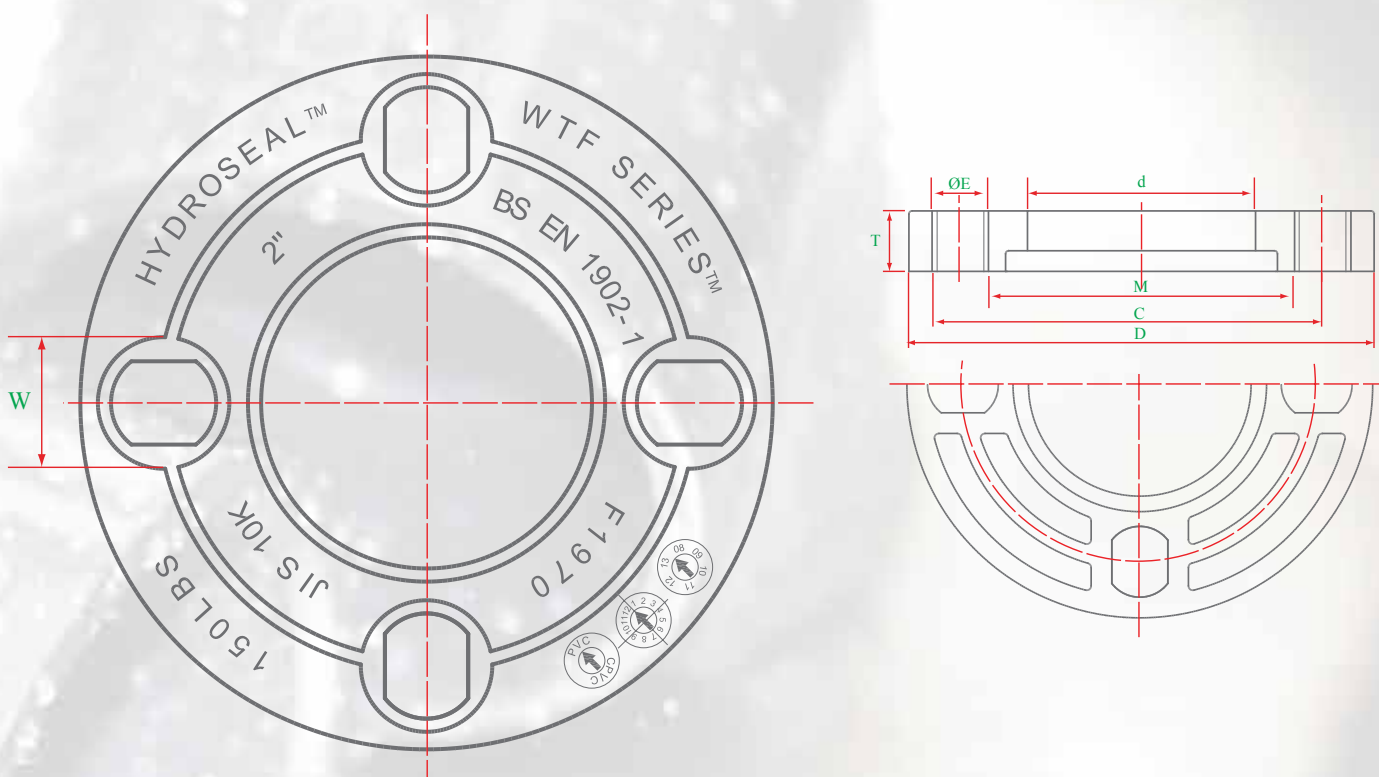

PART	NOMINAL SIZE	WTF FLANGE	UNIT OF MEASURE: MM							
		S x S	d	M	C	D	T	ΦE-N	W	APPROX. WT.
27314	1/2"		31.50	37.00	64.76	95.00	12.00	20.5 - 4	16.00	0.09
27315	3/4"		36.50	42.50	71.80	100.00	13.50	18.0 - 4	16.00	0.11
27316	1"		44.50	51.00	85.20	118.00	15.50	21.8 - 4	17.00	0.18
27317	1 1/4"		53.00	61.50	95.00	128.00	17.00	22.0 - 4	17.00	0.22
27318	1 1/2"		62.00	71.50	105.00	140.00	18.50	22.0 - 4	17.00	0.29
27319	2"		75.50	86.00	120.00	158.00	20.00	24.0 - 4	19.00	0.40
27320	2 1/2"		92.00	100.00	137.00	180.00	23.00	26.0 - 4	19.00	0.58
27321	3"		109.00	119.00	153.10	192.00	27.00	24.0 - 8	19.00	0.75
27322	4"		135.00	151.00	184.20	230.00	28.00	24.0 - 8	19.00	1.10
27325	6"		195.00	206.00	240.00	280.00	31.00	24.0 - 8	24.00	1.80
27329	8"		-	-	-	-	-	-	-	-

**Notes:** Flange bolt hole patterns meet ANSI B16.5 as well as BS 4504.  
 CPVC material meets ASTM Standard D-1784.  
 Dimensions are subject to change without notice. Contact your HYDROSEAL representative for certification.

# ACCESSORIES

## Cements - 45 Callibre PVC Cement

### GENERAL DESCRIPTION:

**Hydroséal® Canada 45 Callibre PVC Cement** is a clear or gray, extra heavy bodied, medium setting, high strength PVC solvent cement for all classes and schedules of pipe and fittings, including Schedule 80, with interference fit through 12 inch diameter and non-pressure applications up to 18 inch diameter. It has good gap filling properties and is recommended for solvent cementing joints where a sizable gap exists between pipe and fitting – e.g. large pipe sizes – and when more working time is required in warm weather.

### APPLICATION:

**Hydroséal® Canada 45 Callibre PVC Cement** can be for use on all types of PVC plastic pipe applications, Type I and Type II. It is suitable for use with potable water pressure systems, irrigation, turf, conduit, industrial pipe applications, sewer, drain, waste and vent systems.

Detailed directions on making solvent cemented joints are printed on the container label. An installation DVD/CD covering solvent cementing is available. It not only describes the basic principles of solvent cementing, but also covers the handling, storage and use of our products. It is highly recommended that the installer review the instructions supplied by the pipe and fitting manufacturer.



**NOTE:** Hydroséal® Canada solvent cements must never be used in a PVC system using or being tested by compressed air or gases; including air-over-water booster.

### STANDARDS AND CERTIFICATION LISTINGS:



- Meets ASTM D 2564 Standard.
- Listed by NSF International for compliance with ASTM D 2564, NSF/ANSI Standard 14 for use on potable water, drain, waste, vent and sewer applications.

### SPECIFICATIONS:

COLOR:	Clear or Gray
RESIN	PVC
SPECIFIC GRAVITY:	0.947 ± 0.04
BROOKFIELD VISCOSITY:	Clear: Minimum 1,600 CP@ 73 ± 2°F (23 ± 1°C) Gray: Minimum 2,000 CP@ 73 ± 2°F (23 ± 1°C)

### SHIPPING:

**For One Liter and Above**  
 Proper Shipping Name: Adhesive  
 Hazard Class: 3  
 Identification Number: UN 1133  
 Packing Group: II  
 Label Required: Flammable Liquid

**For Less than One Liter**  
 Proper Shipping Name: Consumer Commodity  
 Hazard Class: ORM-D

### SHELF LIFE:

3 years in tightly sealed containers. The date code of manufacture is stamped on the bottom of the container. Stability of the product is limited by the evaporation of the solvent when the container is opened. Evaporation of solvent will cause the cement to thicken and reduce its effectiveness. Adding of thinners to change viscosity is not recommended and may significantly change the properties of the cement.

### QUALITY ASSURANCE:

**Hydroséal® Canada 45 Callibre PVC Cement** is evaluated to assure that consistent high quality is maintained. Fourier transform infrared spectroscopy, gas chromatography, and additional in depth testing ensures each batch is manufactured to exacting standards. A batch identification code is stamped on each can and assures traceability of all materials and processes used in manufacturing this solvent cement.

### AVAILABILITY:

PART	SIZE	PVC	45 CALLIBRE				
		DESCRIPTION	COLOR	CARTON	N.W (KGS)	G.W (KGS)	VOL (CU/FT)
74501	4 oz	45 CALLIBRE	CLEAR	24	2.40	3.60	0.29
74502	8 oz			24	4.80	7.20	0.41
74503	16 oz			12	5.40	6.60	0.42
74504	32 oz			12	10.20	13.20	0.78

PART	SIZE	PVC	45 CALLIBRE				
		DESCRIPTION	COLOR	CARTON	N.W (KGS)	G.W (KGS)	VOL (CU/FT)
74506	4 oz	45 CALLIBRE	GREY	24	2.40	3.60	0.29
74507	8 oz			24	4.80	7.20	0.41
74508	16 oz			12	5.40	6.60	0.42
74509	32 oz			12	10.20	13.20	0.78

### GENERAL DESCRIPTION:

**Hydroseal® Canada 40 Callibre PVC Cement** is a clear, heavy bodied, medium setting, high strength PVC solvent cement for all classes and schedules of pipe and fittings with interference fit through 8 inch diameter. Can be used without primer on non-pressure systems if local codes permit.

### APPLICATION:

**Hydroseal® Canada 40 Callibre PVC Cement** is for use on all types of PVC plastic pipe applications, Type I and Type II. It is suitable for use with potable water pressure systems, irrigation, turf, foam core, conduit, sewer, drain, waste and vent systems.

Detailed directions on making solvent cemented joints are printed on the container label. An installation DVD/CD covering solvent cementing is available. It not only describes the basic principles of solvent cementing, but also covers the handling, storage and use of our products. It is highly recommended that the installer review the instructions supplied by the pipe and fitting manufacturer.

**NOTE: Hydroseal® Canada** solvent cements must never be used in a PVC system using or being tested by compressed air or gases; including air-over-water booster.

### STANDARDS AND CERTIFICATION LISTINGS:



- Meets ASTM D 2564 Standard.
- Listed by NSF International for compliance with ASTM D 2564, NSF/ANSI Standard 14 for use on potable water, drain, waste, vent and sewer applications.

### SPECIFICATIONS:

COLOR:	Clear
RESIN:	PVC
SPECIFIC GRAVITY:	0.920 ± 0.04
BROOKFIELD VISCOSITY:	Minimum 500 CP @ 73 ± 2°F (23 ± 1°C)

### SHIPPING:

**For One Liter and Above**  
 Proper Shipping Name: Adhesive  
 Hazard Class: 3  
 Identification Number: UN 1133  
 Packing Group: II  
 Label Required: Flammable Liquid

**For Less than One Liter**  
 Proper Shipping Name: Consumer Commodity  
 Hazard Class: ORM-D

### SHELF LIFE:

3 years in tightly sealed containers. The date code of manufacture is stamped on the bottom of the container. Stability of the product is limited by the evaporation of the solvent when the container is opened. Evaporation of solvent will cause the cement to thicken and reduce its effectiveness. Adding of thinners to change viscosity is not recommended and may significantly change the properties of the cement.

### QUALITY ASSURANCE:

**Hydroseal® Canada 40 Callibre PVC Cement** is carefully evaluated to assure that consistent high quality is maintained. Fourier transform infrared spectroscopy, gas chromatography, and additional in depth testing ensures each batch is manufactured to exacting standards. A batch identification code is stamped on each can and assures traceability of all materials and processes used in manufacturing this solvent cement.

### AVAILABILITY:

PART	SIZE	PVC	40 CALLIBRE				
		DESCRIPTION	COLOR	CARTON	N.W.(KGS)	G.W (KGS)	VOL (CU/FT)
74001	4 oz	40 CALLIBRE	CLEAR	24	2.40	3.60	0.29
74002	8 oz			24	4.80	7.20	0.41
74003	16 oz			12	5.40	6.60	0.42
74004	32 oz			12	10.20	13.20	0.78

# ACCESSORIES

## Cements - 45 Callibre CPVC Cement

SECTION

6

### GENERAL DESCRIPTION:

**Hydroséal® Canada 45 Callibre CPVC Cement** is gray, low VOC emissions extra heavy bodied, medium setting, high strength CPVC solvent cement for all classes and schedules of pipe and fittings with interference fit, including Schedule 80 through 12 inch diameter. Also recommended for PVC industrial piping systems for chemical applications.

### APPLICATION:

**Hydroséal® Canada 45 Callibre CPVC Cement** is especially formulated for use on industrial piping systems (CPVC or PVC) requiring chemical resistance to caustics, including hypochlorite solutions, mineral acids, aggressive water and aqueous salt solutions. Approved for use with Corzan™ Industrial Piping Systems.

Detailed directions on making solvent cemented joints are printed on the container label. An installation DVD/CD covering solvent cementing is available. It not only describes the basic principles of solvent cementing, but also covers the handling, storage and use of our products. It is highly recommended that the installer review the instructions supplied by the pipe and fitting manufacturer.

**NOTE: Hydroséal® Canada** solvent cements must never be used in CPVC and PVC systems using or being tested by compressed air or gases; including air-over-water booster.



### STANDARDS AND CERTIFICATION LISTINGS:



- Meets ASTM F 493 Standard.
- Meets SCAQMD Rule 1168/316A.
- Compliant with LEED® (Leadership in Energy and Environmental Design). When using this **Hydroséal® Canada** low VOC product, credit can be claimed for LEED Green Building Rating System – Indoor Environmental Quality.
- Listed by NSF International for compliance with ASTM F 493, NSF/ANSI Standard 14 for use on potable water, drain, waste, vent and sewer applications.

### SPECIFICATIONS:

COLOR: Gray  
 RESIN: CPVC  
 SPECIFIC GRAVITY: 0.984 ± 0.040  
 BROOKFIELD VISCOSITY: Minimum 2,000 CP  
 @ 73 ± 2°F (23 ± 1°C)

### SHIPPING:

**For One Liter and Above**  
 Proper Shipping Name: Adhesive  
 Hazard Class: 3  
 Identification Number: UN 1133  
 Packing Group: II  
 Label Required: Flammable Liquid

**For Less than One Liter**  
 Proper Shipping Name: Consumer Commodity  
 Hazard Class: ORM-D

### SHELF LIFE:

2 years in tightly sealed containers. The date code of manufacture is stamped on the bottom of the container. Stability of the product is limited by the evaporation of the solvent when the container is opened. Evaporation of solvent will cause the cement to thicken and reduce its effectiveness. Adding of thinners to change viscosity is not recommended and may significantly change the properties of the cement.

### QUALITY ASSURANCE:

**Hydroséal® Canada 45 Callibre CPVC Cement** is carefully evaluated to assure that consistent high quality is maintained. Fourier transform infrared spectroscopy, gas chromatography, and additional in depth testing ensures each batch is manufactured to exacting standards. A batch identification code is stamped on each can and assures traceability of all materials and processes used in manufacturing this solvent cement.

### AVAILABILITY:

PART	SIZE	CPVC		45 CALLIBRE			
		DESCRIPTION	COLOR	CARTON	N.W(KGS)	G.W(KGS)	VOL (CU/FT)
84506	4 oz	45 CALLIBRE	GREY	24	2.40	3.60	0.29
84507	8 oz			24	4.80	7.20	0.41
84508	16 oz			12	5.40	6.60	0.42
84509	32 oz			12	10.20	13.20	0.78

**GENERAL DESCRIPTION:**

**Hydroséal® Canada 40 Callibre CPVC Cement** is an orange, heavy bodied, medium setting, high strength CPVC solvent cement for all classes and schedules of CPVC pipe and fittings with interference fit through 8 inch diameter, including Schedule 80. It has good gap filling properties and its medium set allows more working time in warm weather.

**APPLICATION:**

**Hydroséal® Canada 40 Callibre CPVC Cement** is for use on cold and hot water systems up to 180°F (82°C) maximum, in industrial piping, residential, recreational vehicles and mobile homes plumbing. It can be used on copper tube size CPVC pipe and fittings.

Detailed directions on making solvent cemented joints are printed on the container label. An installation DVD/CD covering solvent cementing is available. It not only describes the basic principles of solvent cementing, but also covers the handling, storage and use of our products. It is highly recommended that the installer review the instructions supplied by the pipe and fitting manufacturer.



**NOTE: Hydroséal® Canada** solvent cements must never be used in a CPVC system using or being tested by compressed air or gases; including air-over-water booster.

**STANDARDS AND CERTIFICATION LISTINGS:**

- Meets ASTM D 2846 and F 493 Standard.
- Listed by NSF International for compliance with ASTM D 2846, NSF/ANSI Standard 14 for use on potable water, drain, waste, vent and sewer applications.

**SPECIFICATIONS:**

COLOR: Orange  
 RESIN: CPVC  
 SPECIFIC GRAVITY: 0.972 ± 0.040  
 BROOKFIELD VISCOSITY: Minimum 1,800 CP  
 @ 73 ± 2°F (23 ± 1°C)

**SHIPPING:**

**For One Liter and Above**  
 Proper Shipping Name: Adhesive  
 Hazard Class: 3  
 Identification Number: UN 1133  
 Packing Group: II  
 Label Required: Flammable Liquid

**For Less than One Liter**

Proper Shipping Name: Consumer Commodity  
 Hazard Class: ORM-D

**SHELF LIFE:**

2 years in tightly sealed containers. The date code of manufacture is stamped on the bottom of the container. Stability of the product is limited by the evaporation of the solvent when the container is opened. Evaporation of solvent will cause the cement to thicken and reduce its effectiveness. Adding of thinners to change viscosity is not recommended and may significantly change the properties of the cement.

**QUALITY ASSURANCE:**

**Hydroséal® Canada 40 Callibre CPVC Cement** is carefully evaluated to assure that consistent high quality is maintained. Fourier transform infrared spectroscopy, gas chromatography, and additional in depth testing ensures each batch is manufactured to exacting standards. A batch identification code is stamped on each can and assures traceability of all materials and processes used in manufacturing this solvent cement.

**AVAILABILITY:**

PART	SIZE	CPVC	40 CALLIBRE				
		DESCRIPTION	COLOR	CARTON	N.W(KGS)	G,W(KGS)	VOL (CU/FT)
84001	4 oz	40 CALLIBRE	ORANGE	24	2.40	3.60	0.29
84002	8 oz			24	4.80	7.20	0.41
84003	16 oz			12	5.40	6.60	0.42
84004	32 oz			12	10.20	13.20	0.78



# ACCESSORIES

## Primer - 90 Callibre Primer

### GENERAL DESCRIPTION:

**Hydroséal® Canada 90 Callibre Primer** is a low VOC emission, non-bodied, fast acting, primer. The strong, aggressive action of **90 Callibre Primer** rapidly softens and dissolves the joining surfaces of PVC and CPVC pipe and fittings. The benefit of this priming action is especially noticeable on parts being joined together in cold weather. Available in clear and purple; the latter allows easy identification when used on the joining surfaces.

### APPLICATION:

**Hydroséal® Canada 90 Callibre Primer**, when used in conjunction with appropriate **Hydroséal® Canada** solvent cements, will make consistently strong, wellfused joints. It is essential that the joining surfaces of pipe and fittings be softened and remains softened prior to assembly. The main function of the primer is to expedite the penetration and softening of the surfaces. Its rate of penetration into the joining surfaces is more rapid than that of solvent cement alone. **90 Callibre Primer** is suitable for use with all types, classes and schedules of PVC and CPVC pipe and fittings.

Detailed directions on making solvent cemented joints are printed on the container label. An installation DVD/CD covering solvent cementing is available. It not only describes the basic principles of solvent cementing, but also covers the handling, storage and use of our products. It is highly recommended that the installer review the instructions supplied by the pipe and fitting manufacturer.

**NOTE: Hydroséal® Canada** solvent cements must never be used in a CPVC system using or being tested by compressed air or gases; including air-over-water booster.



### STANDARDS AND CERTIFICATION LISTINGS:



- Meets ASTM F 656 Standard.
- Meets SCAQMD Rule 1168/316A.
- Compliant with LEED® (Leadership in Energy and Environmental Design). When using this **Hydroséal® Canada** low VOC product, credit can be claimed for LEED Green Building Rating System – Indoor Environmental Quality.
- Listed by NSF International for compliance with ASTM F 656, NSF/ANSI Standard 14 for use on potable water, drain, waste, vent and sewer applications.

### SPECIFICATIONS:

COLOR: Clear or Purple  
 SPECIFIC GRAVITY: 0.858 ± 0.040  
 BROOKFIELD VISCOSITY: Water Thin

### SHIPPING:

**For One Liter and Above**  
 Proper Shipping Name: Flammable Liquid  
 n.o.s. (Methyl Ethyl Ketone, Tetrahydrofuran)  
 Hazard Class: 3  
 Identification Number: UN 1993  
 Packing Group: II  
 Label Required: Flammable Liquid

### For Less than One Liter

Proper Shipping Name: Consumer Commodity  
 Hazard Class: ORM-D

### SHELF LIFE:

3 years in tightly sealed containers. The date code of manufacture is stamped on the bottom of the container. Stability of the product is limited by the evaporation of the solvent when the container is opened. Adding of solvents is not recommended and may significantly change the properties of the primer.

### QUALITY ASSURANCE:

**Hydroséal® Canada 90 Callibre Primer** is carefully evaluated to assure that consistent high quality is maintained. Fourier transform infrared spectroscopy, gas chromatography, and additional in depth testing ensures each batch is manufactured to exacting standards. A batch identification code is stamped on each can and assures traceability of all materials and processes used in manufacturing this product.

### AVAILABILITY:

PART	SIZE	PRIMER	90 CALLIBRE				
		DESCRIPTION	COLOR	CARTON	N.W (KGS)	G.W (KGS)	VOL (CU/FT)
99011	4 oz	90 CALLIBRE	CLEAR	24	2.20	3.40	0.29
99012	8 oz			24	4.80	7.20	0.41
99013	16 oz			12	4.80	6.60	0.42
99014	32 oz			12	9.60	12.00	0.78

PART	SIZE	PRIMER	90 CALLIBRE				
		DESCRIPTION	COLOR	CARTON	N.W (KGS)	G.W (KGS)	VOL (CU/FT)
99016	4 oz	90 CALLIBRE	PURPLE	24	2.20	3.40	0.29
99017	8 oz			24	4.80	7.20	0.41
99018	16 oz			12	4.80	6.60	0.42
99019	32 oz			12	9.60	12.00	0.78